

EJECTOR PINS—ENGLISH—HARDENED & NITRIDED

Tolerances	
Pin Dia (D) P3 - P33	+ .0000/- .0003
Pin Dia (D) P34 - P47	+ .0000/- .0005
Head Dia (H)	+ .000/- .010
Head Thickness (T)	+ .000/- .002
Length (L)	+ .062/- .000

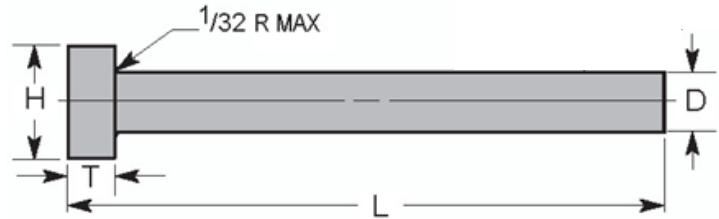

Sample Part No. P5-10

PART NO.	D PIN DIA	-.0003 ACTUAL SIZE	H HEAD DIA	T HEAD THICK.	L = LENGTH																	
					4"			6"			8"			10"			12"			14"		
					STD	STD	.005 OS	STD	STD	.005 OS	STD	STD	.005 OS	STD	STD	.005 OS	STD	STD	.005 OS			
P3-	1/32	.0307	1/8	1/8	X	X	X															
P4-	3/64	.0464	5/32	1/8	X	X	X															
P5-	1/16	.0620	3/16	1/8	X	X	X	X	X	X												
P6-	5/64	.0776	13/64	1/8	X	X	X	X	X	X												
P7-	3/32	.0933	7/32	1/8	X	X	X	X	X	X												
P8-	7/64	.1089	15/64	1/8	X	X	X	X	X	X												
P9-	1/8	.1245	1/4	1/8	X	X	X	X	X	X												
P10-	9/64	.1401	1/4	1/8	X	X	X		X	X	X	X	X									
P11-	5/32	.1557	9/32	5/32	X	X	X	X	X	X				X	X	X						
P12-	11/64	.1714	11/32	3/16	X	X	X		X	X	X	X	X									
P13-	3/16	.1870	3/8	3/16	X	X	X	X	X	X				X	X	X						
P14-	13/64	.2026	3/8	3/16	X	X	X		X	X	X	X	X									
P15-	7/32	.2183	13/32	3/16	X	X	X	X	X	X				X	X	X						
P16-	15/64	.2339	13/32	3/16	X	X			X	X				X	X							
P17-	1/4	.2495	7/16	3/16	X	X	X	X	X	X				X	X	X						
P18-	17/64	.2651	7/16	1/4	X	X			X	X	X	X	X									
P19-	9/32	.2807	7/16	1/4	X	X	X	X	X	X				X	X							
P20-	19/64	.2964	1/2	1/4	X	X			X	X				X	X							
P21-	5/16	.3120	1/2	1/4	X	X	X	X	X	X				X	X							
P22-	21/64	.3276	9/16	1/4	X	X	X		X	X	X	X	X									
P23-	11/32	.3433	9/16	1/4	X	X	X		X	X				X	X							
P24-	23/64	.3589	5/8	1/4	X	X			X	X				X	X							
P25-	3/8	.3745	5/8	1/4	X	X	X	X	X	X				X	X							
P26-	25/64	.3901	37/64	1/4	X	X			X	X	X	X	X									
P27-	13/32	.4057	11/16	1/4	X	X	X		X	X				X	X							
P28-	27/64	.4214	11/16	1/4	X	X			X	X				X	X							
P29-	7/16	.4370	11/16	1/4	X	X			X	X				X	X							
P30-	29/64	.4526	45/64	1/4	X	X			X	X				X	X							
P31-	15/32	.4683	3/4	1/4	X	X			X	X				X	X							
P32-	31/64	.4839	3/4	1/4	X	X			X	X				X	X							
P33-	1/2	.4995	3/4	1/4	X	X	X	X	X	X	X	X	X									
P34-	17/32	.5307	25/32	1/4	X	X			X	X				X	X							
P35-	9/16	.5620	13/16	1/4	X	X			X	X				X	X							
P37-	5/8	.6245	7/8	1/4	X	X			X	X				X	X							
P39-	11/16	.6870	15/16	1/4	X	X			X	X				X	X							
P41-	3/4	.7495	1	1/4	X	X			X	X				X	X							
P45-	7/8	.8745	1-1/8	1/4	X	X			X	X				X	X							
P47-	1	.9995	1-1/4	1/4	X	X			X	X				X	X							

- Surface is hardened to 65-70 Rc
- Core is hardened to 50-52 RC
- Reduces "dishing" effect common to nitrided pins
- Precision ground to 4-10 micro-inch finish
- Manufactured from premium hotwork steel
- Etched for easy identification
- Can be used as an ejector or core pin