

# ***Amcor***

PAD RETAINERS

*Flats hold with wrench*

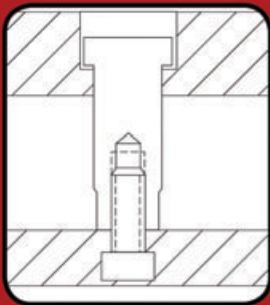

*Flats hold with Locking Pin*

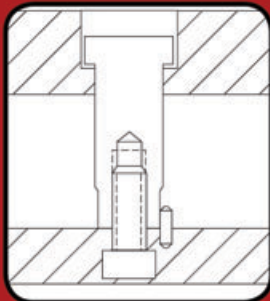

*Holds with lock washer or nyloc screw*

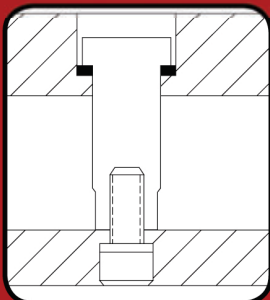

**AVAILABLE IN:**  
***Reversed Style, Locking Style,  
Counterbored Style, Metric  
and Standard***

- *Increase safety and strength to your pad retention*
- *Eliminate stripper bolts*
- *Quick and easy pad removal*
  - *Well stocked*
- *Custom sizes & styles available*
  - *Made in the USA*

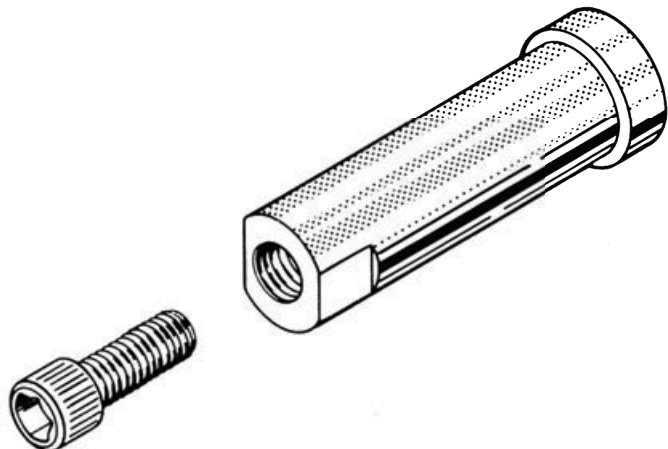



# Reversed Style Pad Retainers

## PR Series

### 0.75" DIAMETER 3/8-16 TAP

ITEM NUMBER	LENGTH
PRO-04	1.00
PRO-05	1.25
PRO-06	1.50
PRO-07	1.75
PRO-08	2.00
PRO-09	2.25
PRO-10	2.50
PRO-11	2.75
PRO-12	3.00
PRO-13	3.25
PRO-14	3.50
PRO-15	3.75
PRO-16	4.00
PRO-18	4.50
PRO-20	5.00
PRO-22	5.50
PRO-24	6.00
PRO-26	6.50

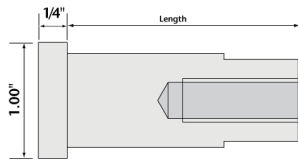

## PR Series

### 0.812" DIAMETER 5/16-18 TAP

ITEM NUMBER	LENGTH
PROX-04	1.00
PROX-05	1.25
PROX-06	1.50
PROX-07	1.75
PROX-08	2.00
PROX-09	2.25
PROX-10	2.50
PROX-11	2.75
PROX-12	3.00
PROX-13	3.25
PROX-14	3.50
PROX-15	3.75
PROX-16	4.00
PROX-18	4.50
PROX-20	5.00
PROX-22	5.50
PROX-24	6.00
PROX-26	6.50

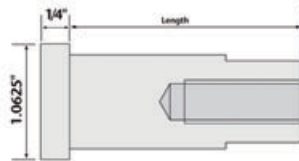

## PR Series

### 1.00" DIAMETER 1/2-13 TAP

ITEM NUMBER	LENGTH
PR1-04	1.00
PR1-05	1.25
PR1-06	1.50
PR1-07	1.75
PR1-08	2.00
PR1-09	2.25
PR1-10	2.50
PR1-11	2.75
PR1-12	3.00
PR1-13	3.25
PR1-14	3.50
PR1-15	3.75
PR1-16	4.00
PR1-18	4.50
PR1-20	5.00
PR1-22	5.50
PR1-24	6.00
PR1-26	6.50

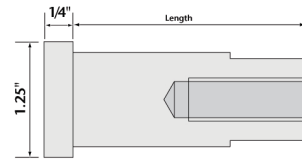

## PR Series

### 1.25" DIAMETER 5/8-11 TAP

ITEM NUMBER	LENGTH
PR2-05	1.25
PR2-06	1.50
PR2-07	1.75
PR2-08	2.00
PR2-09	2.25
PR2-10	2.50
PR2-11	2.75
PR2-12	3.00
PR2-13	3.25
PR2-14	3.50
PR2-15	3.75
PR2-16	4.00
PR2-18	4.50
PR2-20	5.00
PR2-22	5.50
PR2-24	6.00
PR2-26	6.50

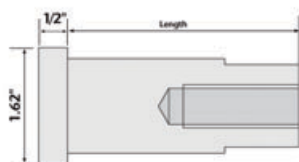

## PR Series

### 1.50" DIAMETER 3/4-10 TAP

ITEM NUMBER	LENGTH
PR3-06	1.50
PR3-07	1.75
PR3-08	2.00
PR3-09	2.25
PR3-10	2.50
PR3-11	2.75
PR3-12	3.00
PR3-13	3.25
PR3-14	3.50
PR3-15	3.75
PR3-16	4.00
PR3-18	4.50
PR3-20	5.00
PR3-22	5.50
PR3-24	6.00
PR3-26	6.50

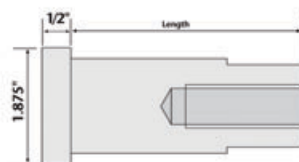

## PT Series

### 0.75" DIAMETER 5/16-18 TAP

ITEM NUMBER	LENGTH
PT0710	1.00
PT0711	1.25
PT0712	1.50
PT0713	1.75
PT0720	2.00
PT0721	2.25
PT0722	2.50
PT0723	2.75
PT0730	3.00
PT0731	3.25
PT0732	3.50
PT0733	3.75
PT0740	4.00
PT0742	4.50
PT0750	5.00
PT0752	5.50
PT0760	6.00
PT0762	6.50

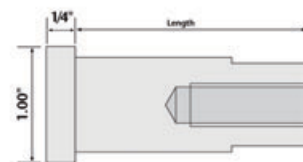

**PT Series**

**1.00" DIAMETER  
3/8-16 TAP**

ITEM NUMBER	LENGTH
PT1010	1.00
PT1011	1.25
PT1012	1.50
PT1013	1.75
PT1020	2.00
PT1021	2.25
PT1022	2.50
PT1023	2.75
PT1030	3.00
PT1031	3.25
PT1032	3.50
PT1033	3.75
PT1040	4.00
PT1042	4.50
PT1050	5.00
PT1052	5.50
PT1060	6.00
PT1062	6.50

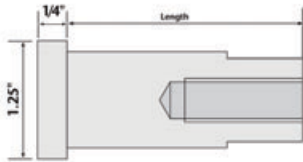

**PT Series**

**1.25" DIAMETER  
1/2-13 TAP**

ITEM NUMBER	LENGTH
PT1111	1.25
PT1112	1.50
PT1113	1.75
PT1120	2.00
PT1121	2.25
PT1122	2.50
PT1123	2.75
PT1130	3.00
PT1131	3.25
PT1132	3.50
PT1133	3.75
PT1140	4.00
PT1142	4.50
PT1150	5.00
PT1152	5.50
PT1160	6.00
PT1162	6.50

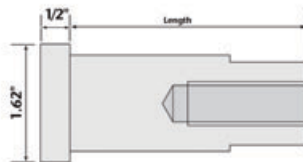

**PT Series**

**1.50" DIAMETER  
5/8-11 TAP**

ITEM NUMBER	LENGTH
PT1212	1.50
PT1213	1.75
PT1220	2.00
PT1221	2.25
PT1222	2.50
PT1223	2.75
PT1230	3.00
PT1231	3.25
PT1232	3.50
PT1233	3.75
PT1240	4.00
PT1242	4.50
PT1250	5.00
PT1252	5.50
PT1260	6.00
PT1262	6.50

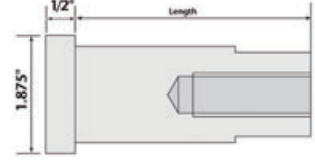

**PC Series**

**0.75" DIAMETER  
5/16" SCREW SIZE**

ITEM NUMBER	LENGTH	COUNTERBORED DEPTH
PC1000	1.00	.50
PC1250	1.25	.50
PC1500	1.50	.50
PC1750	1.75	.50
PC2000	2.00	.50
PC2250	2.25	.50
PC2500	2.50	.50
PC2750	2.75	.50
PC3000	3.00	.50
PC3250	3.25	.50
PC3500	3.50	.75
PC3750	3.75	1.00
PC4000	4.00	1.25
PC4500	4.50	1.75
PC5000	5.00	2.25
PC5500	5.50	2.25
PC6000	6.00	2.50
PC6500	6.50	3.00

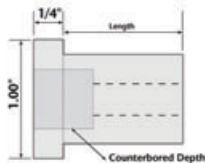

**PRC Series**

**1.00" DIAMETER  
3/8" SCREW SIZE**

ITEM NUMBER	LENGTH	COUNTERBORED DEPTH
PRC1000	1.00	.50
PRC1250	1.25	.50
PRC1500	1.50	.50
PRC1750	1.75	.50
PRC2000	2.00	.50
PRC2250	2.25	.50
PRC2500	2.50	.50
PRC2750	2.75	.50
PRC3000	3.00	.50
PRC3250	3.25	.50
PRC3500	3.50	.75
PRC3750	3.75	1.00
PRC4000	4.00	1.25
PRC4500	4.50	1.75
PRC5000	5.00	2.25
PRC5500	5.50	2.25
PRC6000	6.00	2.50
PRC6500	6.50	3.00

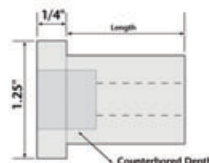

**XPC Series**

**1.25" DIAMETER  
1/2" SCREW SIZE**

ITEM NUMBER	LENGTH	COUNTERBORED DEPTH
XPC1500	1.50	.625
XPC1750	1.75	.625
XPC2000	2.00	.625
XPC2250	2.25	.625
XPC2500	2.50	.625
XPC2750	2.75	.625
XPC3000	3.00	.625
XPC3250	3.25	.625
XPC3500	3.50	.75
XPC3750	3.75	1.00
XPC4000	4.00	1.25
XPC4500	4.50	1.75
XPC5000	5.00	2.25
XPC5500	5.50	2.25
XPC6000	6.00	2.50
XPC6500	6.50	3.00

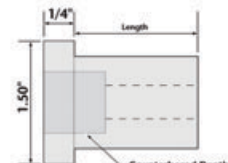



# Metric Pad Retainers

## Reversed Style Spool

### 20mm DIAMETER M8 TAP

ITEM NUMBER	LENGTH
MPT02040	40
MPT02045	45
MPT02050	50
MPT02055	55
MPT02060	60
MPT02065	65
MPT02070	70
MPT02080	80
MPT02090	90
MPT20100	100
MPT20110	110
MPT20120	120
MPT20130	130
MPT20140	140
MPT20150	150

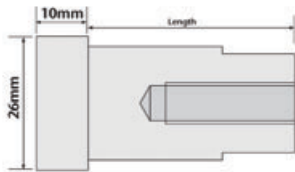

## Reversed Style Spool

### 25mm DIAMETER M10 TAP

ITEM NUMBER	LENGTH
MPT02540	40
MPT02545	45
MPT02550	50
MPT02555	55
MPT02560	60
MPT02565	65
MPT02570	70
MPT02580	80
MPT02590	90
MPT25100	100
MPT25110	110
MPT25120	120
MPT25130	130
MPT25140	140
MPT25150	150

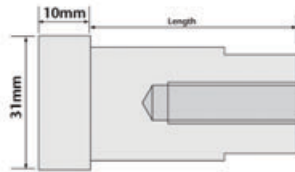

## Reversed Style Spool

### 32mm DIAMETER M12 TAP

ITEM NUMBER	LENGTH
MPT03240	40
MPT03245	45
MPT03250	50
MPT03255	55
MPT03260	60
MPT03265	65
MPT03270	70
MPT03280	80
MPT03290	90
MPT32100	100
MPT32110	110
MPT32120	120
MPT32130	130
MPT32140	140
MPT32150	150

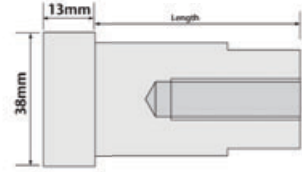

## Locking Style Spool

### 25mm DIAMETER M-10 SCREW SIZE

ITEM NUMBER	LENGTH
MPL02540	40
MPL02545	45
MPL02550	50
MPL02555	55
MPL02560	60
MPL02565	65
MPL02570	70
MPL02580	80
MPL02590	90
MPL25100	100
MPL25110	110
MPL25120	120
MPL25130	130
MPL25140	140
MPL25150	150

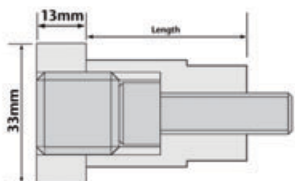

## Locking Style Spool

### 32mm DIAMETER M-12 SCREW SIZE

ITEM NUMBER	LENGTH
MPL03240	40
MPL03245	45
MPL03250	50
MPL03555	55
MPL03260	60
MPL03265	65
MPL03270	70
MPL03280	80
MPL03290	90
MPL32100	100
MPL32110	110
MPL32120	120
MPL32130	130
MPL32140	140
MPL32150	150

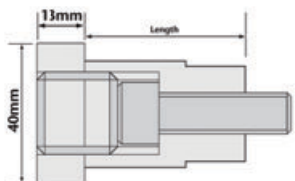

• Amcor Pad Retainers are made from **12L14CRS**

• File hardened to a case depth of **.005/.010**

• Tensile strength is greater than **70,000 PSI**, but less than **85,000**

• Rockwell rating is **C-60** or better

• Tolerances:  
Length:  $\pm .002$   
Diameter:  $+.010$



# Locking Style Pad Retainers

## PLF Series

### 0.75" DIAMETER WITH FLATS 5/16-18 SHCS

ITEM NUMBER	LENGTH
PLF60710	1.00
PLF60711	1.25
PLF60712	1.50
PLF60713	1.75
PLF60720	2.00
PLF60721	2.25
PLF60722	2.50
PLF60723	2.75
PLF60730	3.00
PLF60731	3.25
PLF60732	3.50

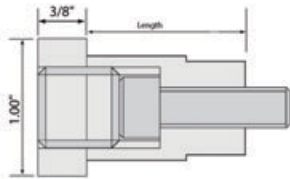

## PLF Series

### 0.812" DIAMETER WITH FLATS 5/16-18 SHCS

ITEM NUMBER	LENGTH
PLF60810	1.00
PLF60811	1.25
PLF60812	1.50
PLF60813	1.75
PLF60820	2.00
PLF60821	2.25
PLF60822	2.50
PLF60823	2.75
PLF60830	3.00
PLF60831	3.25
PLF60832	3.50
PLF60840	4.00
PLF60842	4.50
PLF60850	5.00
PLF60852	5.50
PLF60860	6.00
PLF60862	6.50

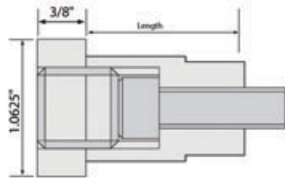

## PLF Series

### 1.00" DIAMETER WITH FLATS 3/8-16 SHCS

ITEM NUMBER	LENGTH
PLF61010	1.00
PLF61011	1.25
PLF61012	1.50
PLF61013	1.75
PLF61020	2.00
PLF61021	2.25
PLF61022	2.50
PLF61023	2.75
PLF61030	3.00
PLF61031	3.25
PLF61032	3.50
PLF61033	3.75
PLF61040	4.00
PLF61042	4.50
PLF61050	5.00
PLF61052	5.50
PLF61060	6.00
PLF61062	6.50

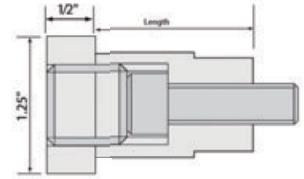

## PLF Series

### 1.25" DIAMETER WITH FLATS 1/2-13 SHCS

ITEM NUMBER	LENGTH
PLF61110	1.00
PLF61111	1.25
PLF61112	1.50
PLF61113	1.75
PLF61120	2.00
PLF61121	2.25
PLF61122	2.50
PLF61123	2.75
PLF61130	3.00
PLF61131	3.25
PLF61132	3.50
PLF61133	3.75
PLF61140	4.00
PLF61142	4.50
PLF61150	5.00
PLF61152	5.50
PLF61160	6.00
PLF61162	6.50

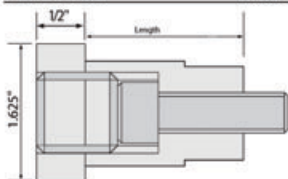

## PLF Series

### 1.50" DIAMETER WITH FLATS 5/8-11 SHCS

ITEM NUMBER	LENGTH
PLF61211	1.25
PLF61212	1.50
PLF61213	1.75
PLF61220	2.00
PLF61221	2.25
PLF61222	2.50
PLF61223	2.75
PLF61230	3.00
PLF61231	3.25
PLF61232	3.50
PLF61233	3.75
PLF61240	4.00
PLF61242	4.50
PLF61250	5.00
PLF61252	5.50
PLF61260	6.00
PLF61262	6.50

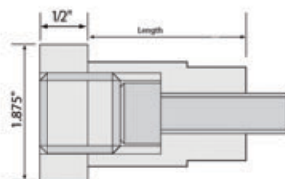

## PLF Series

### 1.62" DIAMETER WITH FLATS 3/4-10 SHCS

ITEM NUMBER	LENGTH
PLF61312	1.50
PLF61313	1.75
PLF61320	2.00
PLF61321	2.25
PLF61322	2.50
PLF61323	2.75
PLF61330	3.00
PLF61331	3.25
PLF61332	3.50
PLF61333	3.75
PLF61340	4.00
PLF61342	4.50
PLF61350	5.00
PLF61352	5.50
PLF61360	6.00
PLF61362	6.50

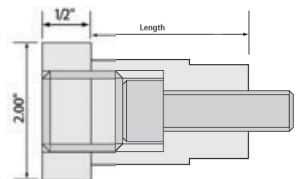



# Counterbored Pad Retainers

## Metric Counterbored Series

### 20mm DIAMETER M8 SCREW SIZE

ITEM NUMBER	LENGTH	COUNTERBORED DEPTH
MS2030	30	15
MS2035	35	15
MS2040	40	15
MS2045	45	15
MS2050	50	15
MS2055	55	15
MS2060	60	15
MS2065	65	15
MS2070	70	15
MS2080	80	27
MS2090	90	27
MS20100	100	27
MS20110	110	27
MS20120	120	27
MS20130	130	27
MS20140	140	27
MS20150	150	27

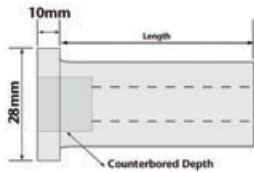

## Metric Counterbored Series

### 25mm DIAMETER M10 SCREW SIZE

ITEM NUMBER	LENGTH	COUNTERBORED DEPTH
MS2530	30	15
MS2535	35	15
MS2540	40	15
MS2545	45	15
MS2550	50	15
MS2555	55	15
MS2560	60	15
MS2565	65	15
MS2570	70	15
MS2580	80	27
MS2590	90	27
MS25100	100	27
MS25110	110	27
MS25120	120	27
MS25130	130	27
MS25140	140	27
MS25150	150	27

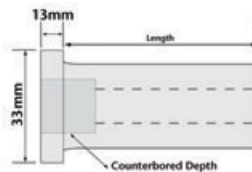

## Metric Counterbored Series

### 32mm DIAMETER M12 SCREW SIZE

ITEM NUMBER	LENGTH	COUNTERBORED DEPTH
MS3240	40	16
MS3245	45	16
MS3250	50	16
MS3255	55	16
MS3260	60	16
MS3265	65	16
MS3270	70	16
MS3280	80	32
MS3290	90	32
MS32100	100	32
MS32110	110	32
MS32120	120	32
MS32130	130	32
MS32140	140	32
MS32150	150	32

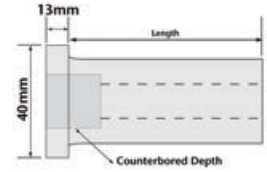

## Set Screws

### STANDARD

ITEM NUMBER	LENGTH	A	B
SHSS0625	5/8-18	3/8	3/8
SHSS0688	11/16-18	3/8	3/8
SHSS0750	3/4-16	3/8	3/8
SHSS0875	7/8-14	3/8	3/8
SHSS1000	1-14	3/8	3/8
SHSS1125	1 1/8-12	3/8	3/8
SHSS1250	1 1/4-12	3/8	3/8
SHSS1500	1 1/2-12	3/8	3/8

### METRIC

ITEM NUMBER	LENGTH	A	B
SHSS18	M18 X 1.50	10	10
SHSS20	M20 X 1.50	10	10
SHSS22	M22 X 1.50	10	10
SHSS24	M24 X 1.50	10	10

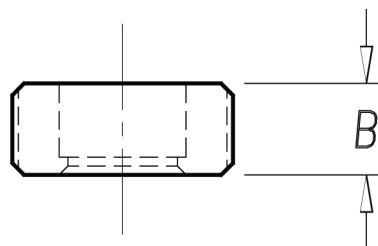
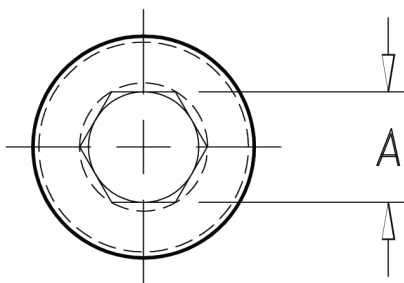

DISTRIBUTED BY:



Applied Mechanics Corporation  
 0-14122 Ironwood Drive N.W.  
 Grand Rapids, MI 49534  
 Toll Free: 800-572-0141  
 Toll Free Fax: 866-677-5969  
 Internet: [www.amcortooling.com](http://www.amcortooling.com)  
 E-mail: [sales@amcortooling.com](mailto:sales@amcortooling.com)  
 Facebook:  
[www.facebook.com/amcortooling](http://www.facebook.com/amcortooling)



**Set Screws**

**STANDARD**

ITEM NUMBER	LENGTH	A	B
SHSS0625	5/8-18	3/8	3/8
SHSS0688	11/16-18	3/8	3/8
SHSS0750	3/4-16	3/8	3/8
SHSS0875	7/8-14	3/8	3/8
SHSS1000	1-14	3/8	3/8
SHSS1125	1 1/8-12	3/8	3/8
SHSS1250	1 1/4-12	3/8	3/8
SHSS1500	1 1/2-12	3/8	3/8

**METRIC**

ITEM NUMBER	LENGTH	A	B
SHSS18	M18 X 1.50	10	10
SHSS20	M20X 1.50	10	10
SHSS22	M22 X 1.50	10	10
SHSS24	M24 X 1.50	10	10

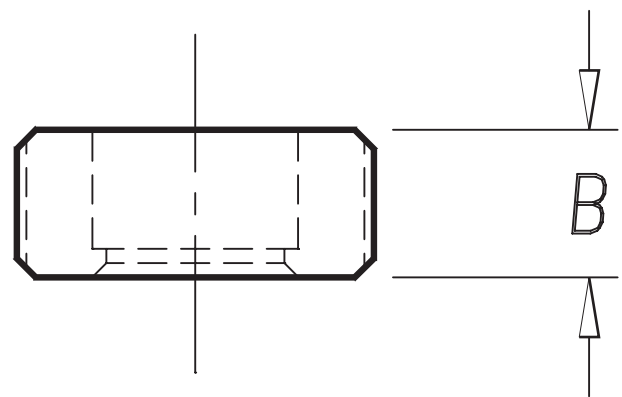
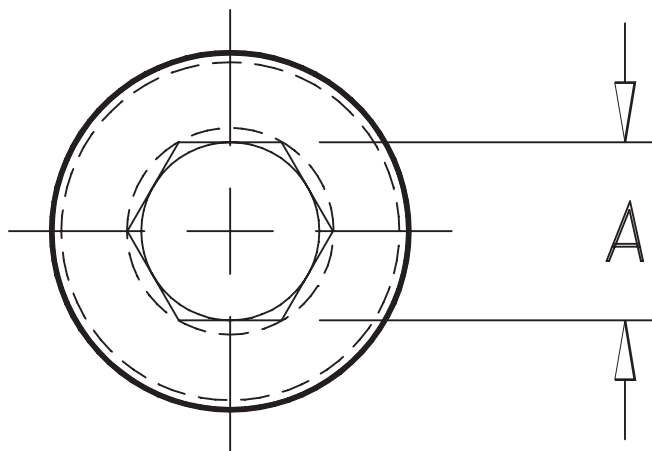

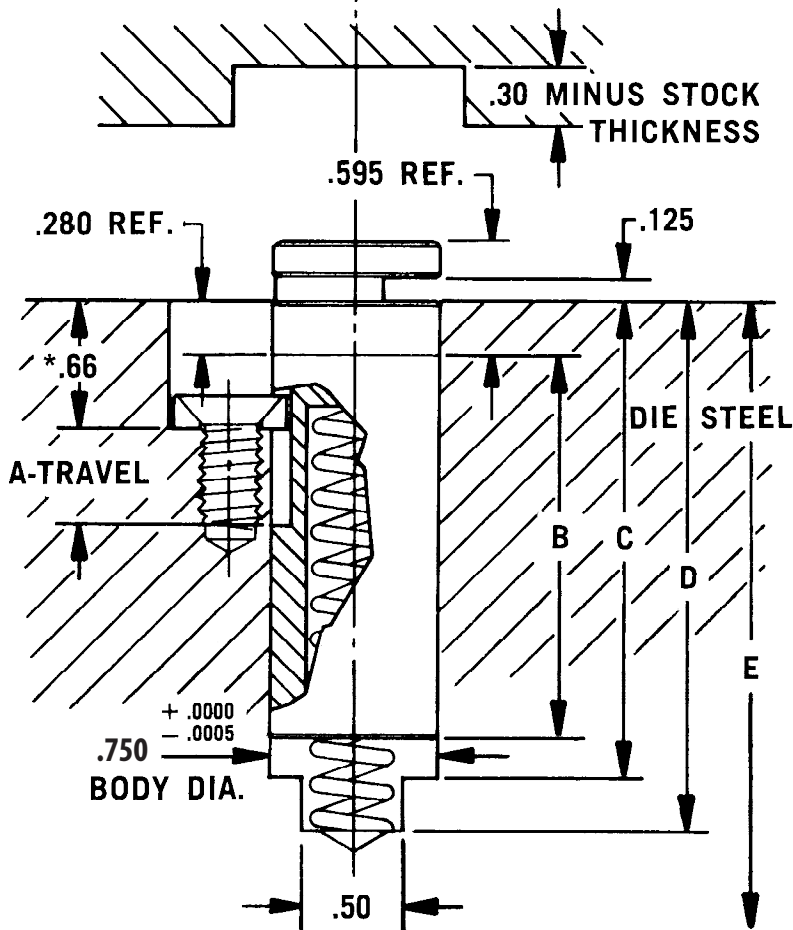
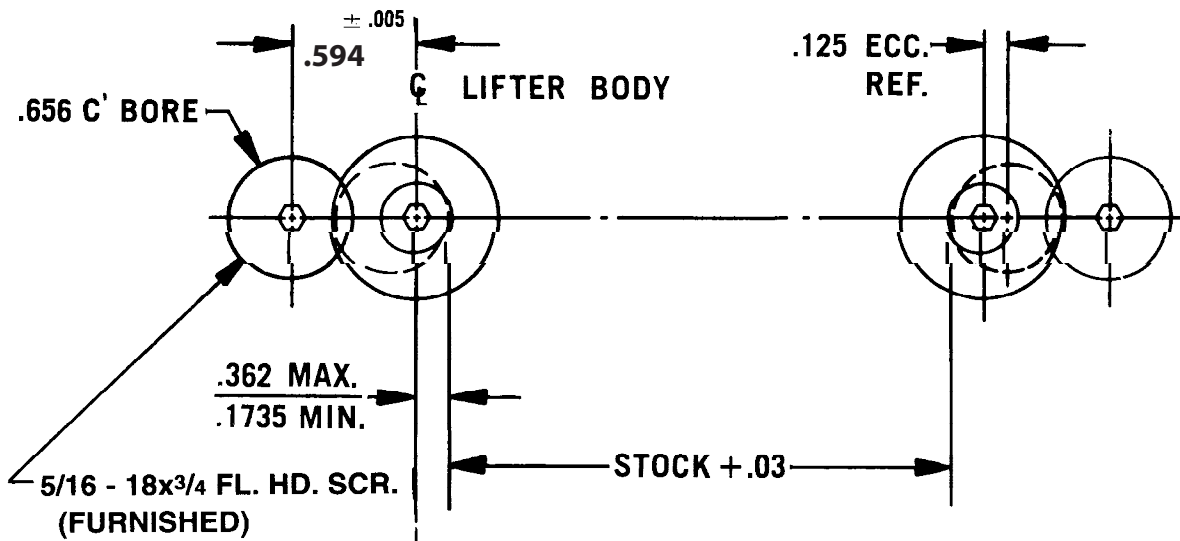

# MODEL - SLC

STANDARD ADJUSTABLE STOCK LIFTER

**BODY DIAMETER 0.750**

UP TO  $\frac{3}{32}$ " THICK STOCK

APPROX. 8# LIFTING PRESSURE  
IN UP POSITION

MODEL NO. (STD)	A	B	C	D	E	MODEL NO. HEAD	MODEL NO. RAIL
SLC-0.50	0.500	1.781	2.440	2.780	3.000	SLC-0.50H	SLRC-0.50
SLC-0.75	0.750	2.031	2.690	3.220	3.750	SLC-0.75H	SLRC-0.75
SLC-1.00	1.000	2.281	2.940	3.750	4.620	SLC-1.00H	SLRC-1.00
SLC-1.25	1.250	2.531	3.190	4.280	5.500	SLC-1.25H	SLRC-1.25
SLC-1.50	1.500	2.781	3.440	4.810	6.380	SLC-1.50H	SLRC-1.50
SLC-1.75	1.750	3.031	3.690	5.340	7.250	SLC-1.75H	SLRC-1.75
SLC-2.00	2.000	3.281	3.940	5.780	8.000	SLC-2.00H	SLRC-2.00

\*DEPTH IS FOR STANDARD TRAVEL INCREMENTS OF  $\frac{1}{4}$  INCH

# Amcor

## TOOLING ACCESSORIES

### Adjustable Stock Lifter

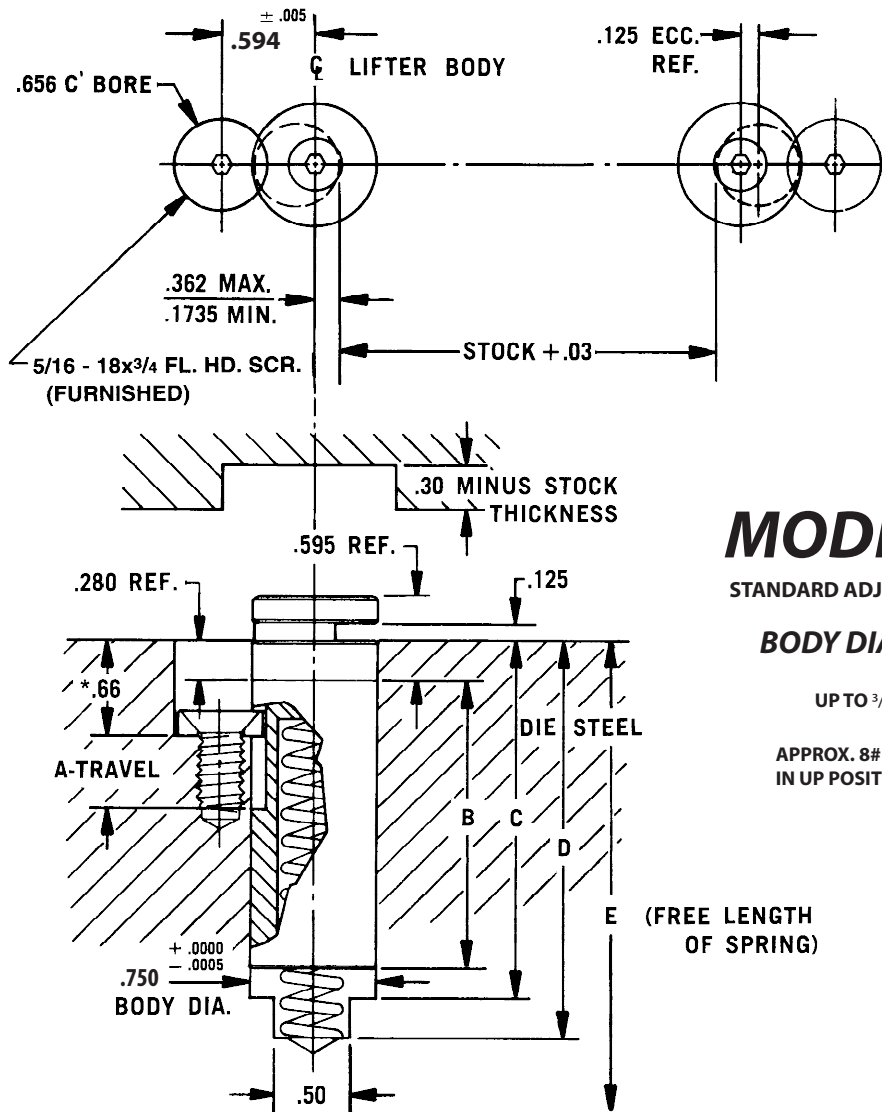

## MODEL - SLC

STANDARD ADJUSTABLE STOCK LIFTER

**BODY DIAMETER 0.750**

UP TO 3/32" THICK STOCK

APPROX. 8# LIFTING PRESSURE  
IN UP POSITION

MODEL NO. (STD)	A	B	C	D	E	MODEL NO. HEAD	MODEL NO. RAIL
SLC-0.50	0.500	1.781	2.440	2.780	3.000	SLC-0.50H	SLRC-0.50
SLC-0.75	0.750	2.031	2.690	3.220	3.750	SLC-0.75H	SLRC-0.75
SLC-1.00	1.000	2.281	2.940	3.750	4.620	SLC-1.00H	SLRC-1.00
SLC-1.25	1.250	2.531	3.190	4.280	5.500	SLC-1.25H	SLRC-1.25
SLC-1.50	1.500	2.781	3.440	4.810	6.380	SLC-1.50H	SLRC-1.50
SLC-1.75	1.750	3.031	3.690	5.340	7.250	SLC-1.75H	SLRC-1.75
SLC-2.00	2.000	3.281	3.940	5.780	8.000	SLC-2.00H	SLRC-2.00

\*DEPTH IS FOR STANDARD TRAVEL INCREMENTS OF 1/4 INCH

Applied Mechanics Corp. • 14122 Ironwood Dr. NW • Grand Rapids, MI 49534  
 800-572-0141 • fax: 866-677-5969 • email: sales@amcortooling.com  
 www.amcortooling.com • www.facebook.com/amcortooling



# ADJUSTABLE STOCK LIFTERS

U.S. PATENT NO. 3368383

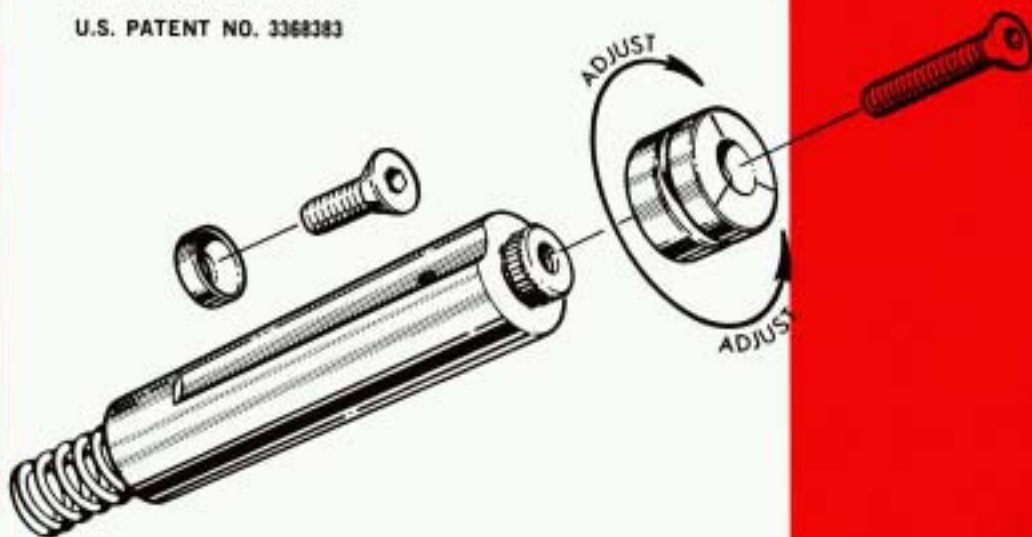

**RUGGED  
PRECISION  
LONG LIFE  
ADJUSTABLE**

- HARDENED & PRECISION GROUND
- INTERCHANGEABLE - REPLACEABLE HEADS
- ENGINEERED SPRINGS FOR UNIFORM LOADS AND LONG LIFE
- ADJUSTABLE GUIDE SLOT - ONE BORE LOCATION
- MINIMUM SPRING DEPTH - RELATIVE TO STROKE
- STOCKED - NATIONWIDE DISTRIBUTION
- ADAPTERS - FOR CUSTOM RAILS
- MARKED FOR EASY ALIGNMENT
- VENTED

DISTRIBUTED BY

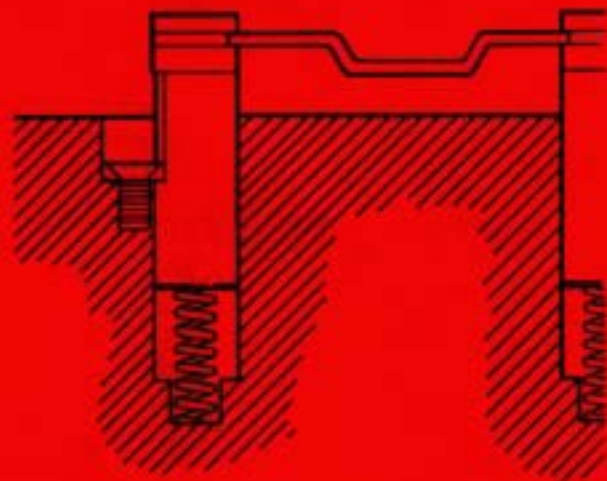

Manufactured by

**APPLIED MECHANICS CORP.**

14200 IRONWOOD DRIVE, GRAND RAPIDS, MICHIGAN 49504  
616-977-1355 FAX 616-977-5969

SEE FOLLOWING PAGES FOR FULL SCALE TRACING TEMPLATES

PRINTED IN U.S.A.



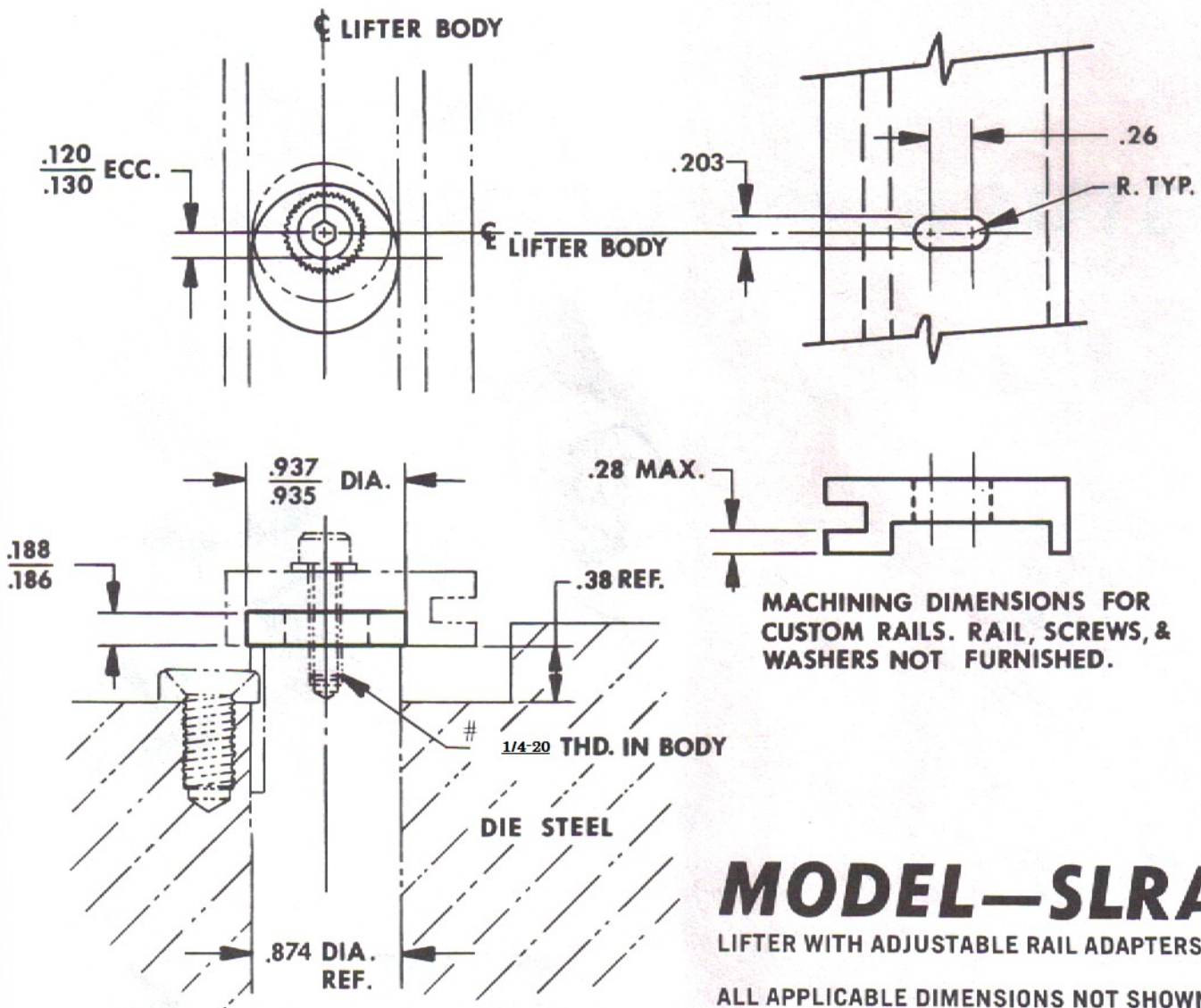

MODEL NO. (STD)	MODEL NO. (RAIL)	A	B	C	D	E	STD. MODEL HEAD
SLA - .50	SLRA - .50	.50	2.00	2.44	2.78	3.00	SLA - .50 H
" - .75	" - .75	.75	2.25	2.69	3.22	3.75	" - .75 H
" - 1.00	" - 1.00	1.00	2.50	2.94	3.75	4.62	" - 1.00 H
" - 1.25	" - 1.25	1.25	2.75	3.19	4.28	5.50	" - 1.25 H
" - 1.50	" - 1.50	1.50	3.00	3.44	4.81	6.38	" - 1.50 H
" - 1.75	" - 1.75	1.75	3.25	3.69	5.34	7.25	" - 1.75 H
" - 2.00	" - 2.00	2.00	3.50	3.94	5.78	8.00	" - 2.00 H
" - 2.50	" - 2.50	2.50	4.00	4.44	5.78	8.00	" - 2.50 H

WHEN ORDERING — SPECIFY QUANTITY AND COMPLETE MODEL OR PART NO.

WHEN ORDERING REPLACEMENT HEADS ONLY — GIVE MODEL NO.  
COMPLETE WITH SUFFIX "H" AS SHOWN

EACH LIFTER COMES PACKAGED COMPLETE — BODY, HEAD (OR RAIL  
ADAPTER), SPRING, SCREWS & RETAINER



**STOP**

**FOR POSITIVE GAGING OF STRIP OR COIL STOCK**



U. S. Pat. No. 3,358,539

- ▶ **EASY-TO-FOLLOW INSTALLATION INSTRUCTIONS FURNISHED WITH EACH AUTOMATIC STOP.**
- ▶ **INDIVIDUALLY PACKAGED, INCLUDING LOCK PIN AND SOCKET HEAD MOUNTING SCREWS. TRIP SPRING AND SCREWS FURNISHED.**
- ▶ **STOCKED NATIONWIDE FOR IMMEDIATE DELIVERY.**
- ▶ **RIGHT TO LEFT STOCK ORDER – AS**  
**LEFT TO RIGHT STOCK ORDER – AS-4L**

DISTRIBUTED BY

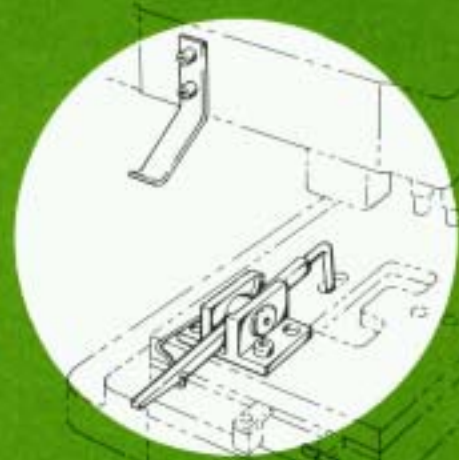

SEE SEPARATE PRICE SCHEDULE

Manufactured by

**APPLIED MECHANICS CORP.**

14200 IRONWOOD DRIVE, GRAND RAPIDS, MICHIGAN 49504  
818-877-1355 FAX 818-877-5089

SEE FOLLOWING PAGES FOR FULL SCALE TRACING TEMPLATES

Made in U.S.A.

Printed in U.S.A.

# AMCOR AUTOMATIC STOP NO. AS-1, AS-1-4L

- ◆ MOUNT BASE AT MOST CONVENIENT LOCATION.
- ◆ LOCK GAGING ARM AT EXACT FRONT TO BACK POSITION, BY DRILLING HOLE THRU ARM, (USING HARDENED PIVOT PIN AS DRILL BUSHING), AND INSERT PRESS FIT ROLL PIN.
- ◆ FOR DIE CLEARANCE CONDITIONS, GAGING ARM MAY BE BENT IF REQUIRED. (SEE TEMPLATE FOR AS-3)
- ◆ USE DOWELS WHEN AN ACCURATE GAGING LOCATION IS REQUIRED.
- ◆ CASE HARDEN FINGER END OF GAGING ARM AS REQUIRED.
- ◆ ATTACH TRIP SPRING TO PUNCH OR PUNCH-HOLDER AND BEND TO ADJUST. (APPLIES TO MODELS AS-1, AS-2 AND AS-3)
- ◆ FOR TRIPPING OF MODEL AS-4, SEE TEMPLATE.

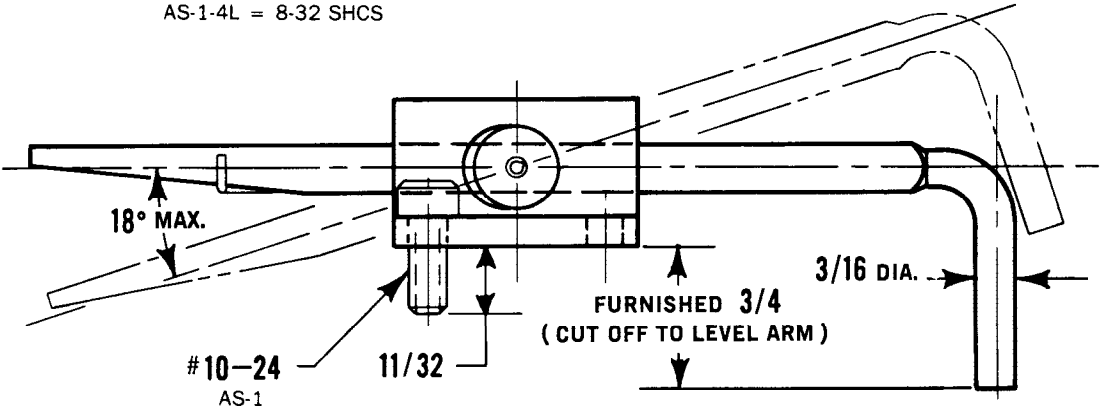
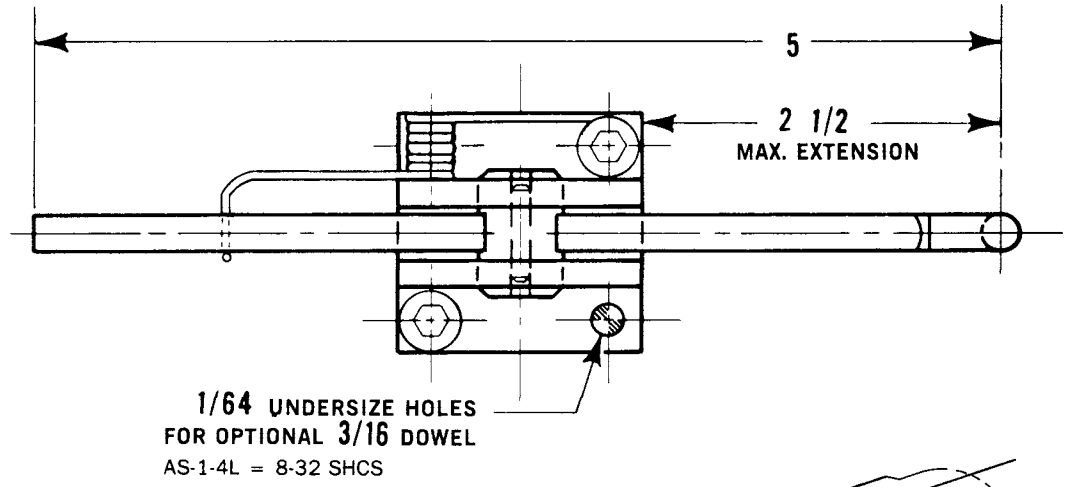

# AMCOR AUTOMATIC STOP NO. AS-2, AS-2-4L

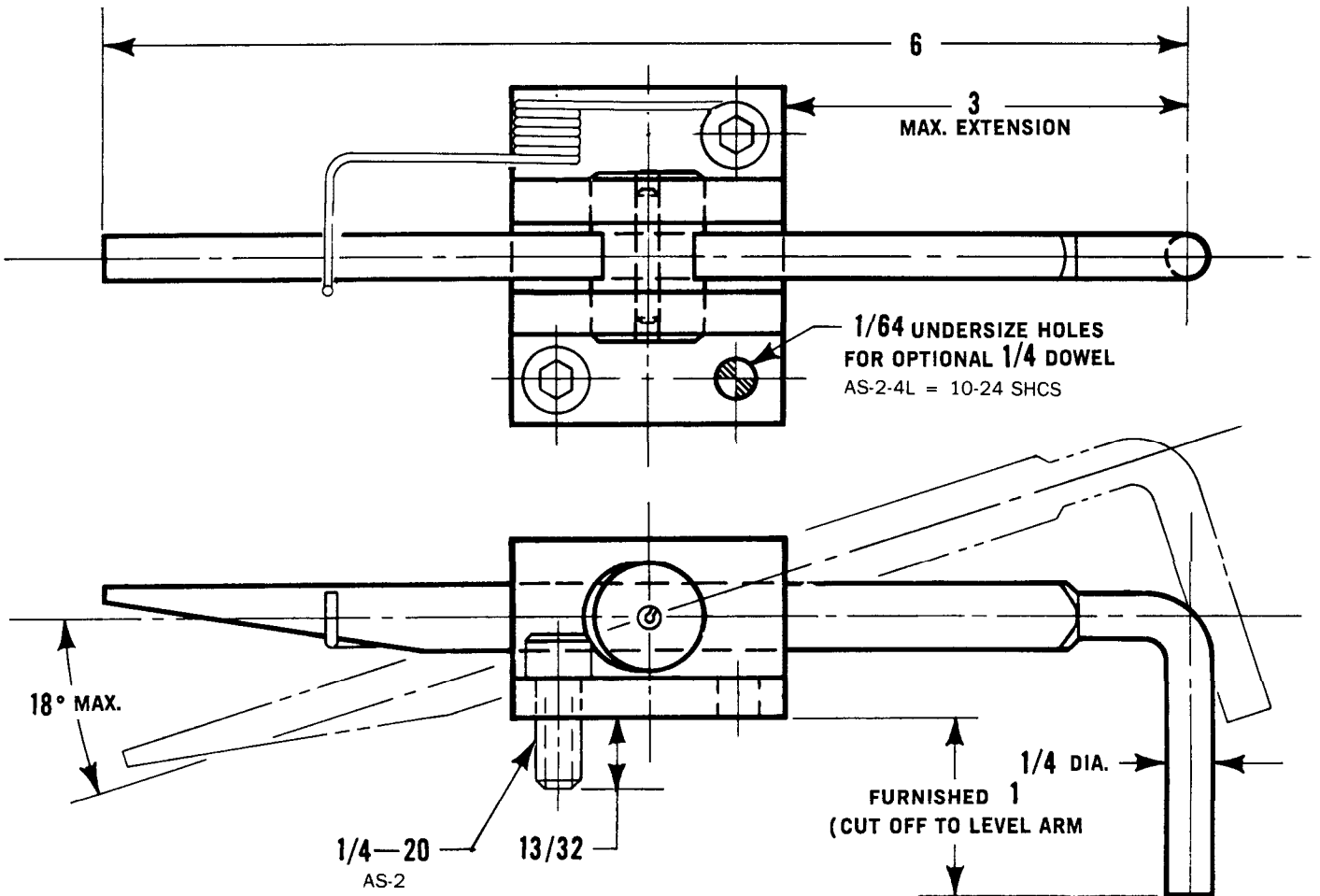

# AMCOR AUTOMATIC STOP NO. AS-3, AS-3-4L

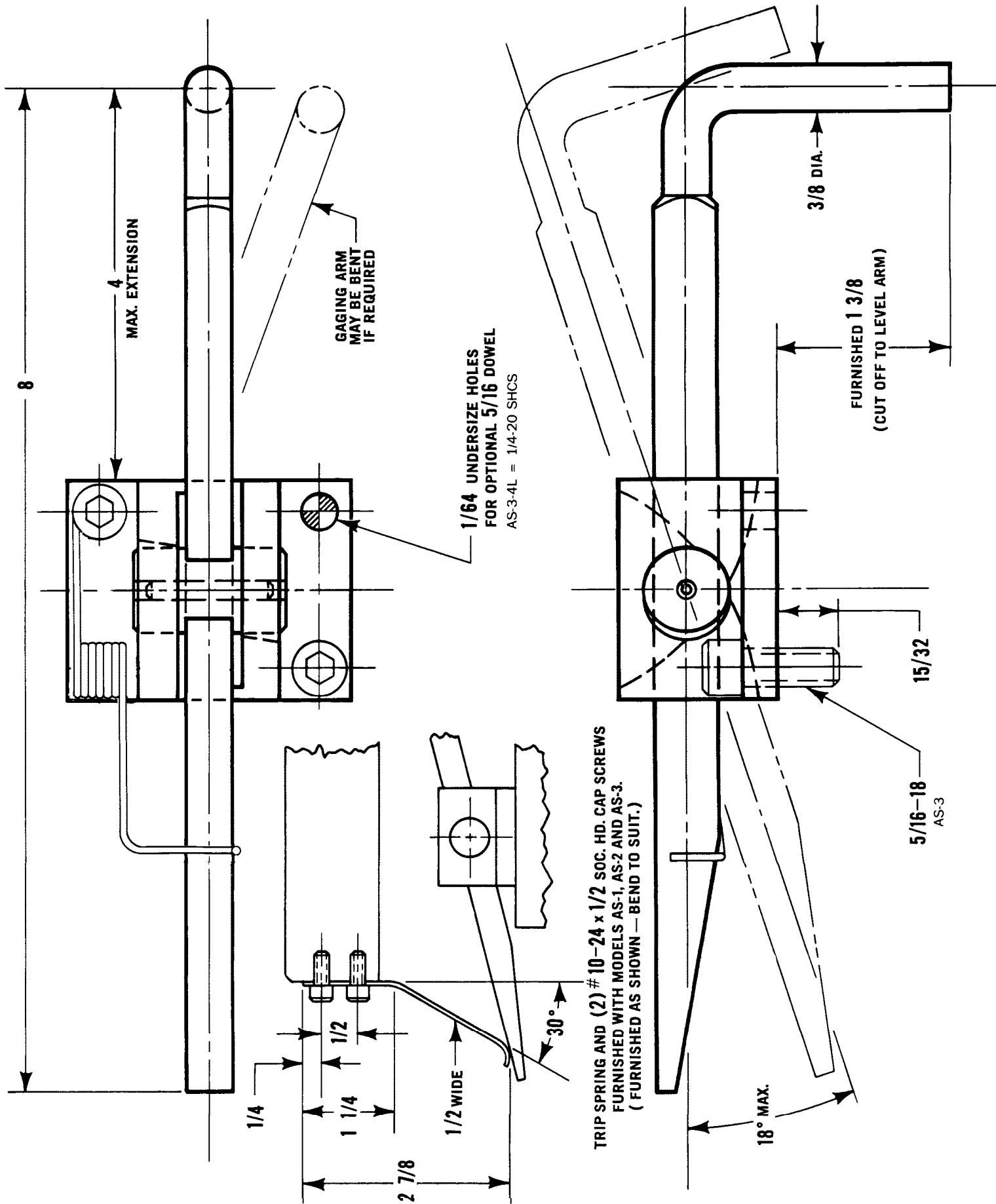

# AMCOR AUTOMATIC STOP NO. AS-4, AS-4-4L

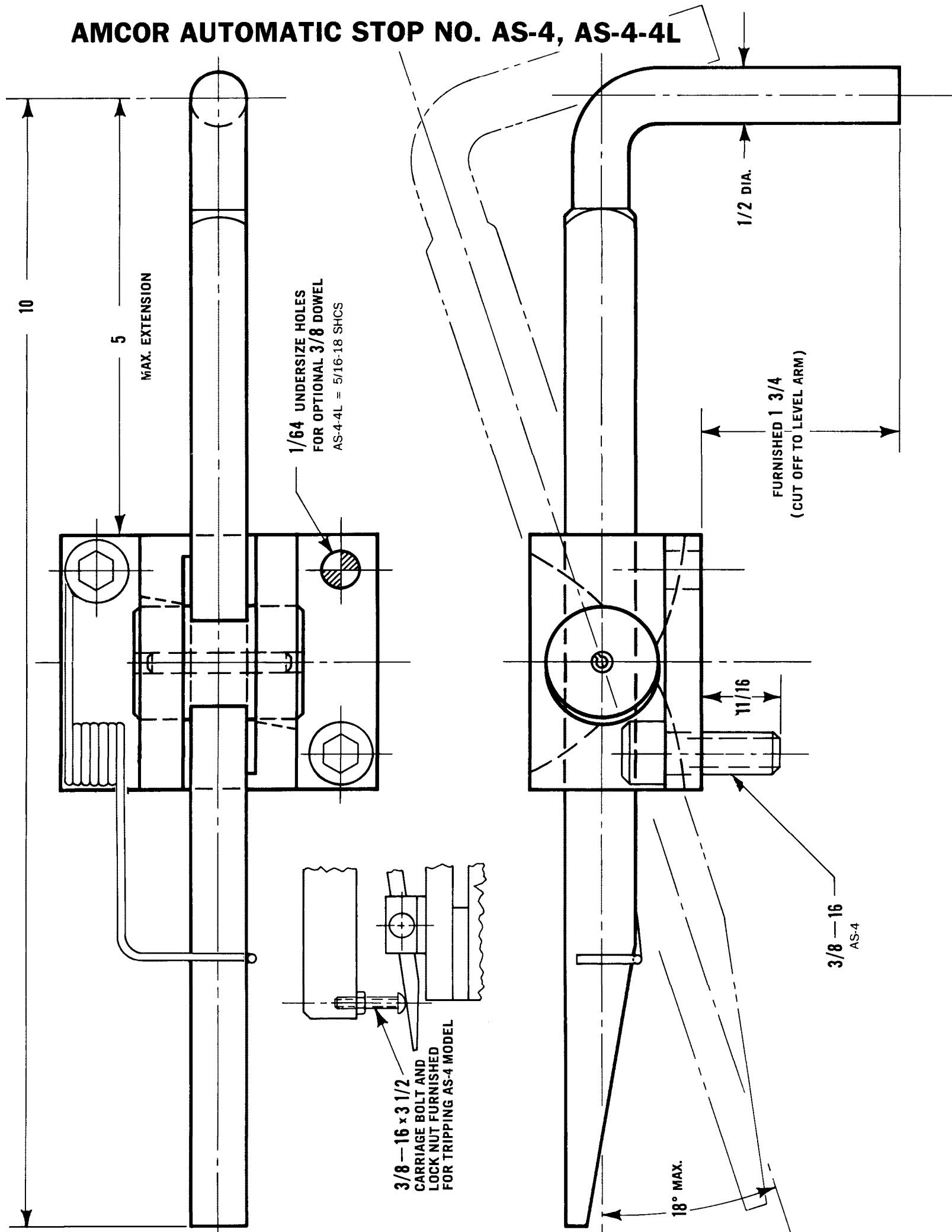

# *Amcor* DIE STOP PINS

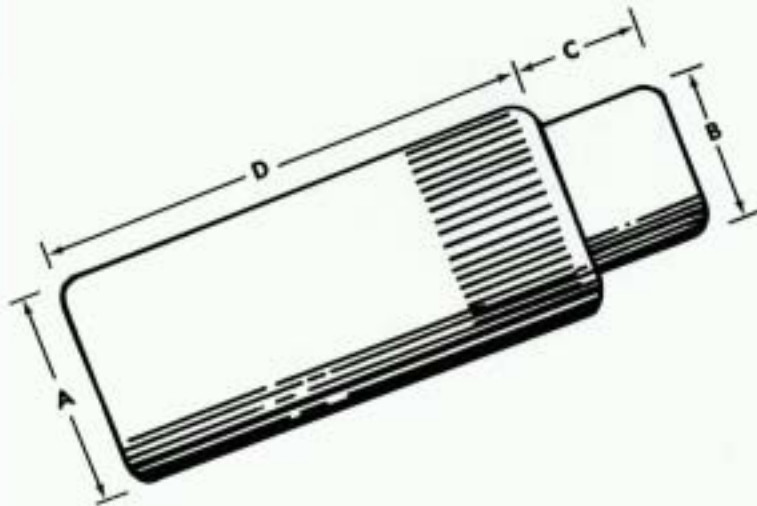

- DRILL & REAM HOLE
- PRESS IN PLACE
- RUGGED
- CASE HARDENED PIN
- SIMPLICITY OF INSTALLATION
- CAD PLATED – NO RUST
- COMPACT – MIN. SPACE REQ'D
- NUMEROUS APPLICATIONS

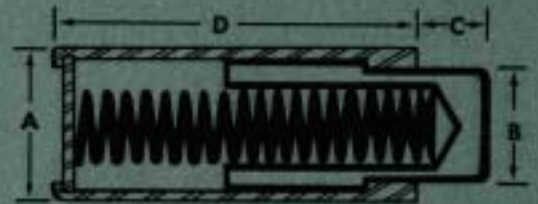

STOCK NO.	A	B	C	D	APPROX END PRESSURE
DSP-2	1/2	3/8	1/4	1-1/8	3-1/2 lbs.
DSP-4	3/8	1/4	3/16	25/32	3 lbs.
DSP-6	5/16	3/16	3/16	9/16	2-1/2 lbs.
DSP-8	1/4	5/32	1/8	1/2	1-1/4 lbs.



ACTUAL SIZE

*DISTRIBUTED BY*

Packed Twelve Per Package  
Sold in Full Packs Only  
Order by Stock Number

*SEE SEPARATE PRICE SCHEDULE*

Manufactured by

**APPLIED MECHANICS CORP.**

14200 IRONWOOD DRIVE, N.W. • GRAND RAPIDS, MI 49504  
616-677-1355 • FAX 616-677-5969

SEE SEPARATE PRICE SCHEDULE.

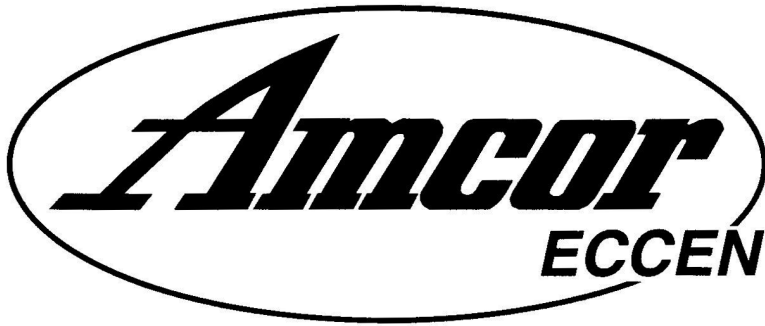

# ECCENTRIC GAUGE STOPS

FOR POSITIVE ON-PRESS ADJUSTMENTS

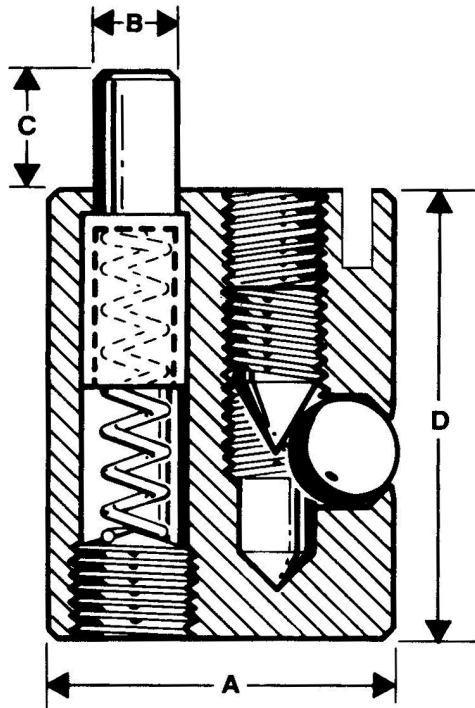

- DRILL & REAM HOLE
- DROP IN PLACE
- REVOLVE TO ADJUST
- SLOT TO ASSIST IN ADJUSTMENT
- SET SCREW TO LOCK
- CASE HARDENED PIN

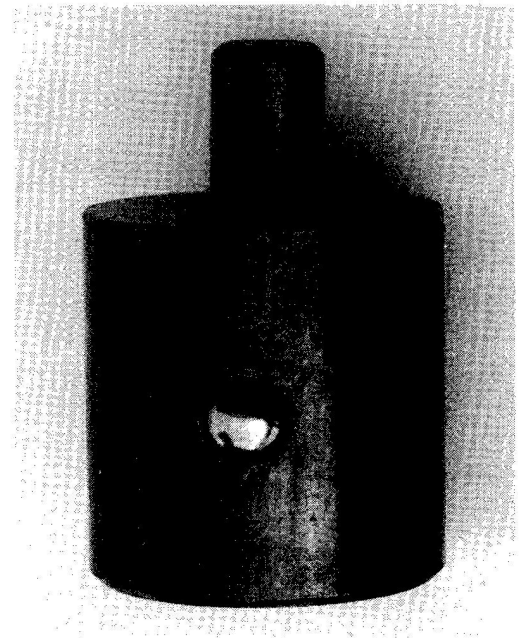

Item No.	A	B	C	D	MAX ADJ.
EGS - 1	.499	.156	.156	.750	.218
EGS - 2	.748	.187	.187	1.000	.375
EGS - 3	.998	.250	.312	1.312	.500
EGS - 4	1.240	.375	.500	1.312	.500
EGS - 5	1.240	.500	1.000	2.000	.625
EGS - 6	1.240	.500	1.000	2.500	.625

**DISTRIBUTED BY**

**ORDER BY ITEM NUMBER  
SEE SEPARATE PRICE SCHEDULE**

MADE IN U.S.A

**Manufactured by  
APPLIED MECHANICS CORP.**

14122 Ironwood Drive, N.W., Grand Rapids, Michigan 49534  
Telephone: 800-572-0141 Fax: 616-677-5969

# *Amcor* GRIPPER BUTTONS

FOR MANY POSITIVE  
STOCK GRIPPING REQUIREMENTS

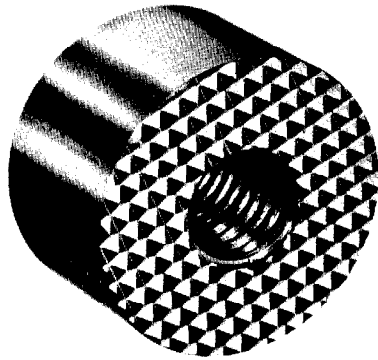

*With these important advantages*

- 1** **LOW COST!** Quantity production brings your cost to a fraction of what it costs you to make your own.
- 2** **PRECISION GROUND DIAMETERS** — For easy installation and replacement. (Provided with jack-screw hole for easy removal).
- 3** **Manufactured of special alloy steel & hardened for LONG POINT WEAR.**
- 4** **Available in (5) sizes and stocked by distributors nationally and in Canada.**

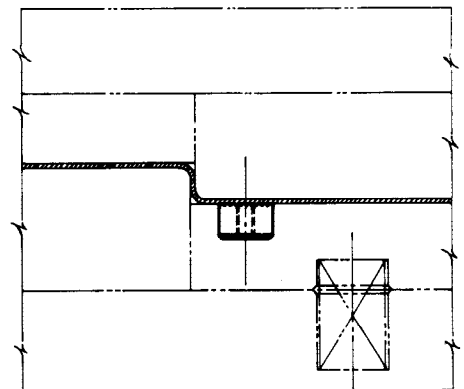
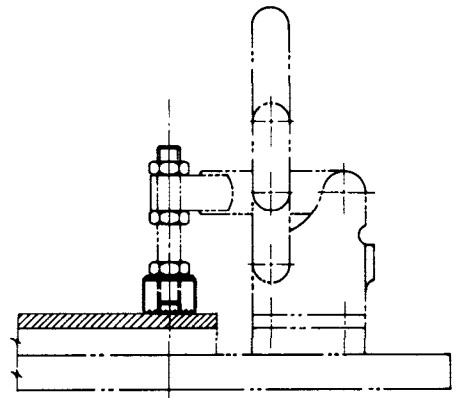
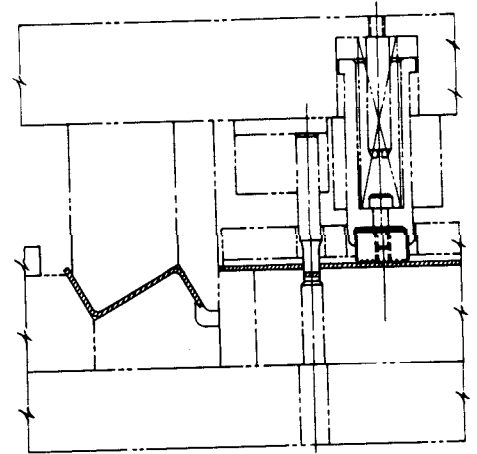

*Manufactured by*

**APPLIED MECHANICS CORP.**

14200 IRONWOOD DRIVE, GRAND RAPIDS, MICHIGAN 49544  
616-677-1355 FAX 616-677-5969

SEE REVERSE SIDE FOR TRACING TEMPLATES AND INSTALLATION INSTRUCTIONS



**GRIPPER BUTTONS**

FULL SCALE TRACING TEMPLATES

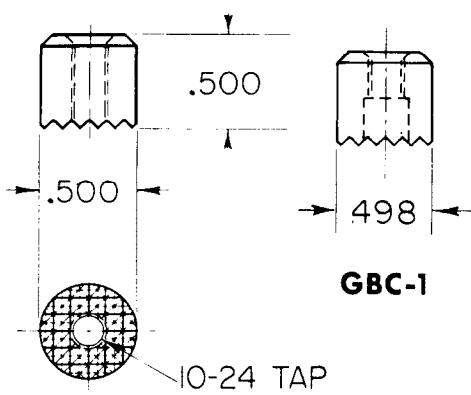

**GB-1**

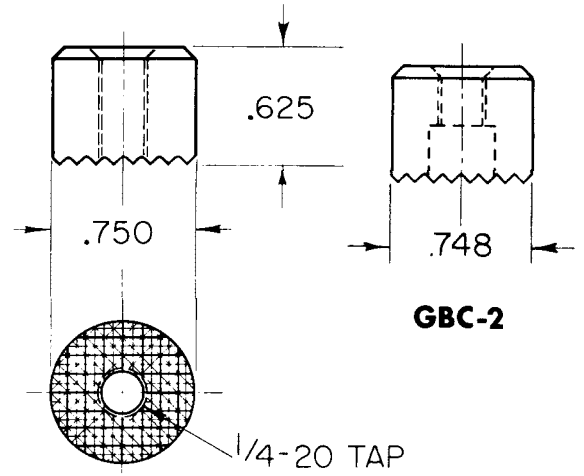

**GB-2**

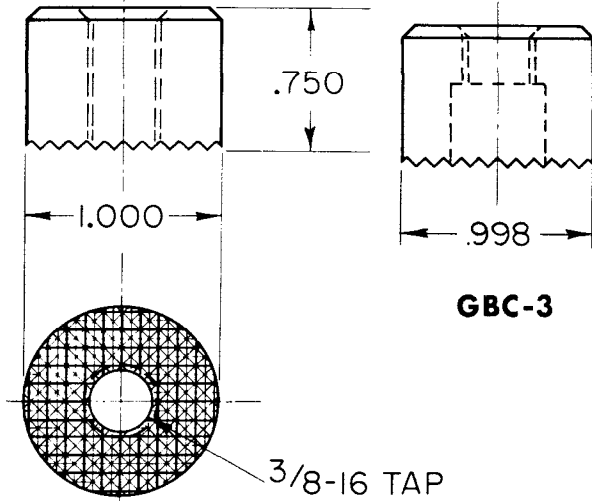

**GB-3**

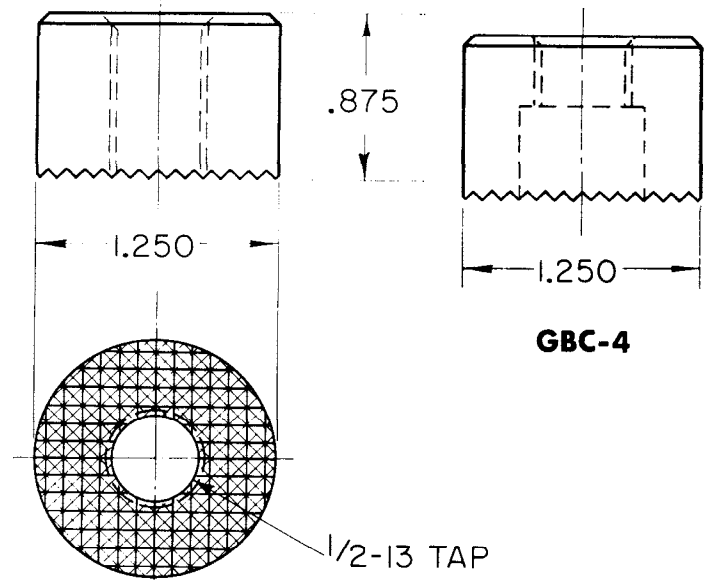

**GB-4**

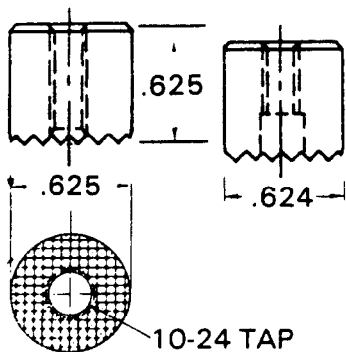

**GB-5**

**GB-5**  
COUNTERSUNK  
FOR #6 CAP  
SCREW

**NOTE:** AMCOR Gripper Buttons are hardened and Precision ground to specified diameters with tolerances of  $+.0002$  to  $+.0007$  and lengths are finished to specified dimensions with tolerances of  $-.000$  to  $+.010$ .

**SEE SEPARATE PRICE SCHEDULE**  
**GBC SERIES (SAME AS GB SERIES)**  
**D I S T R I B U T E D   B Y**

**APPLIED MECHANICS CORP.**

14200 IRONWOOD DRIVE, GRAND RAPIDS, MICHIGAN 49544  
616-677-1355

PRINTED IN U.S.A.



## Guide Post Oiler

- CONSTANT UNIFORM LUBRICATION
- SOLUTION TO SCORING AND SHEARING
- SAVES ON COSTLY EQUIPMENT
- THOUSANDS OF STROKES TROUBLE FREE
- MADE FROM AN OIL RESISTANT RUBBER COMPOUND

Item No.	Guide Post Size	O.D.*
GPO .625	5/8 DIA.	2.25
GPO .750	3/4 DIA.	2.25
GPO 1.00	1" DIA.	2.25
GPO 1.25	1-1/4" DIA.	2.50
GPO 1.50	1-1/2" DIA.	2.87
GPO 1.75	1-3/4" DIA.	3.12
GPO 2.00	2" DIA.	3.50
GPO 2.50	2-1/2" DIA.	4.25
GPO 3.00	3" DIA.	5.00

\*Clearance DIA. Required for Oiler in Die  
NOTE: GPO .750 Can be used on 7/8" post

**DISTRIBUTED BY**

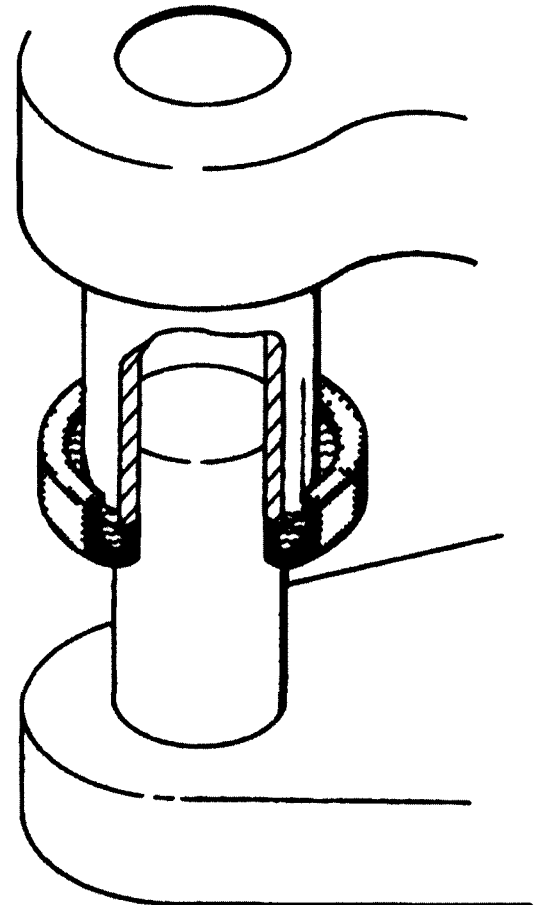

**ORDER BY ITEM NUMBER  
SEE SEPARATE PRICE SCHEDULE**

MADE IN U.S.A

Manufactured by  
**APPLIED MECHANICS CORP.**

14200 Ironwood Drive, N.W., Grand Rapids, Michigan 49544-1094  
Telephone: 800-572-0140 Fax: 616-677-5969



## **\*MATERIAL POSITIONER/RELEASE #12**

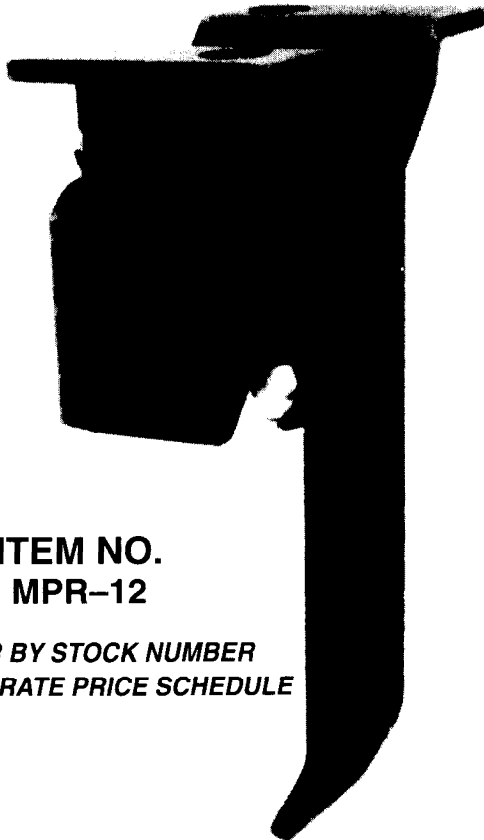

**ITEM NO.  
MPR-12**

**ORDER BY STOCK NUMBER  
SEE SEPARATE PRICE SCHEDULE**

- **ADJUST ARM TO PRESSURE DESIRED, 2 TO 20 lbs.**
- **.06 CENTER PUNCH FOR OPTIONAL DOWELLING 2 PLACES ON BASE**
- **1/4-20 x 1/2 SOC. HD. SCREW FURNISHED (2) DOWELS AND SLIDE NOT FURNISHED**

**DISTRIBUTED BY**

- **AUTOMATICALLY PUSHES MATERIAL TO POSITIVE LOCATION AS DIE CLOSURES VIA SLIDE (Not Furnished)**
- **AS THE DIE IS OPENED THE MATERIAL IS RELEASED FOR EASY FEEDING OF STOCK STRIP**

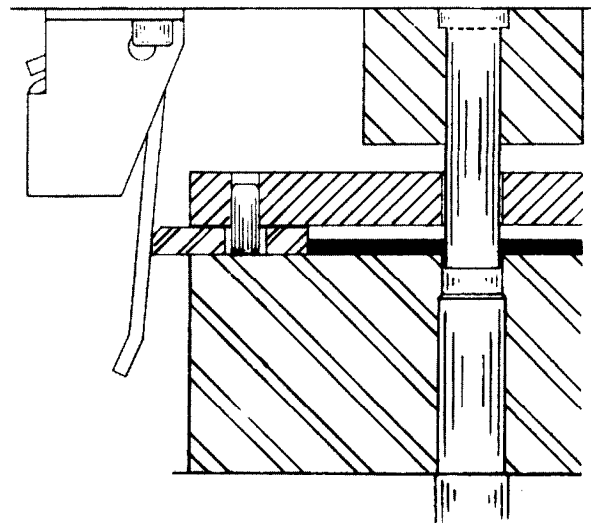

**TRACING TEMPLATES ON REVERSE SIDE  
\*PATENT PENDING**

MADE IN U.S.A.

**Manufactured by  
APPLIED MECHANICS CORP.**

14200 Ironwood Drive, N.W., Grand Rapids, Michigan 49544-1094  
Telephone: 800-572-0140 Fax: 616-677-5969



TRACING TEMPLATES

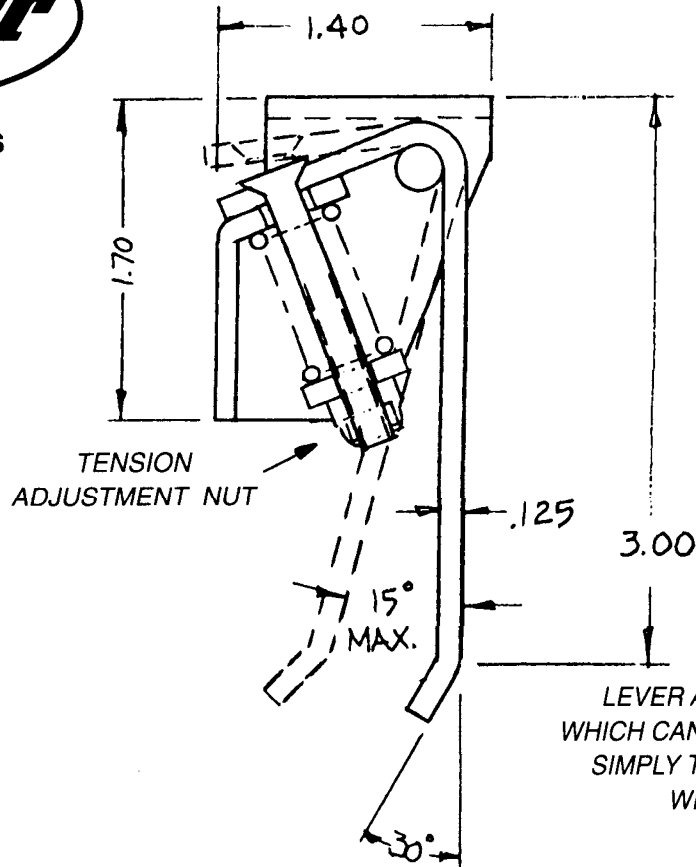

LEVER ARM IS C-1074 ANNEALED WHICH CAN BE ALTERED TO SUIT; THEN SIMPLY TORCH HARDEN FACE FOR WEAR IF SO DESIRED.

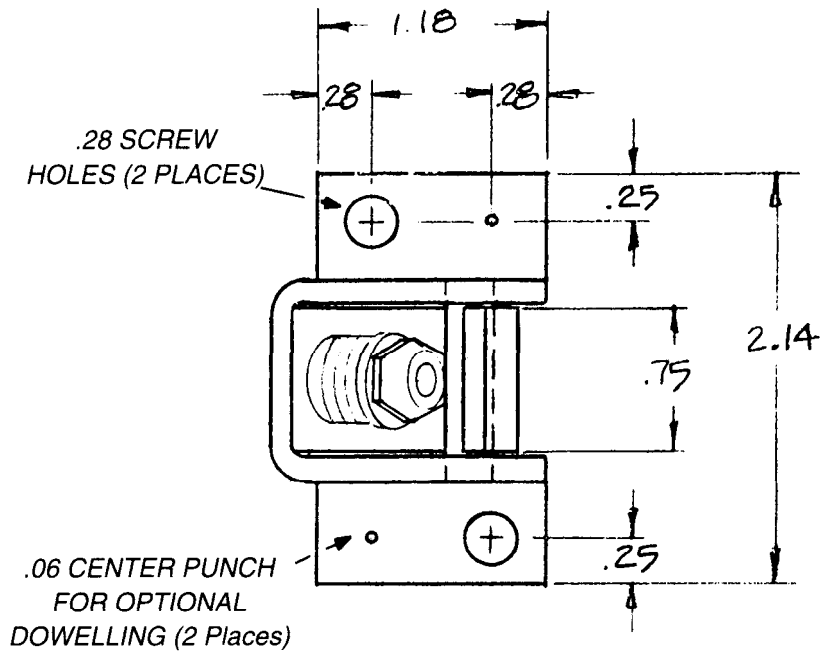

MADE IN U.S.A.

Manufactured by  
**APPLIED MECHANICS CORP.**

14200 Ironwood Drive, N.W., Grand Rapids, Michigan 49544-1094  
Telephone: 800-572-0140 Fax: 616-677-5969



# PLUNGER PINS

ECONOMICAL, VERSATILE, STURDY SPRING PINS.  
FOR USE AS OIL SEAL BREAKER PINS, STRIPPER  
PINS AND MANY OTHER APPLICATIONS.

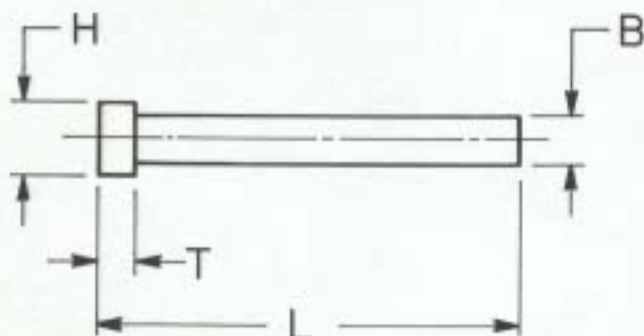

LENGTH OF PINS CAN  
BE CUT TO SUIT APPLICATION  
MADE OF CRS—CASE HARDENED AND GROUND

ITEM NO.	B BODY DIA.	H HEAD DIA.	T HEAD HGT.	L LENGTH
PP-1	3/32	3/16	1/8	1 1/2
PP-1A	1/8	1/4	1/8	1 1/2
PP-2	1/4	3/8	3/16	1 1/2
PP-2A	5/16	1/2	3/16	2 1/2
PP-3	3/8	1/2	3/16	2 1/2
PP-3A	7/16	11/16	1/4	2 1/2
PP-4	1/2	5/8	1/4	2 1/2

NOTE: DIAMETERS GIVEN ARE NOMINAL,  
ACTUAL BODY DIAMETERS ARE  
GROUND  $-.002$  TO  $-.0025$  UNDER NOR-  
MAL SIZES. HEAD DIAMETERS ARE  
 $-.003$  TO  $-.007$  UNDER SIZES GIVEN.

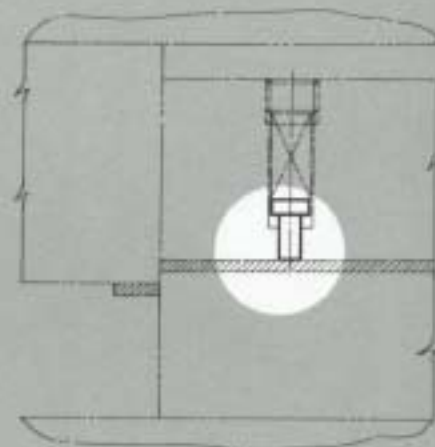

USED AS OIL SEAL BREAKER

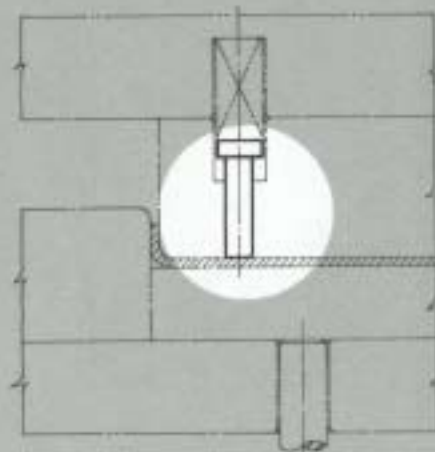

USED AS STRIPPER PIN

## TYPICAL APPLICATIONS

DISTRIBUTED BY

PACKED TWELVE PER BOX  
SOLD IN FULL BOXES ONLY  
ORDER BY STOCK NUMBER

SEE SEPARATE PRICE SCHEDULE

Manufactured by

**APPLIED MECHANICS CORP.**

14200 IRONWOOD DRIVE, N.W. • GRAND RAPIDS, MI 49504  
616-677-1355 • FAX 616-677-5969

PRINTED IN U.S.A.



# PRIMARY FINGER STOPS

Provided in thicker sizes – to eliminate the expense and bother of making the thicker sizes by hand as in the past.

ITEM NO.	"A" DIMENSION
FS-2	1/8"
FS-3	3/16"
FS-4	1/4"
FS-5	5/16"
FS-6	3/8"

*Packed 12 per box, Including Springs*

**HARDENING NOTE:**

AMCOR Primary Finger Stops are manufactured of 1020 C.R.S.

**ORDER BY ITEM NUMBER  
SEE SEPARATE PRICE SCHEDULE  
DISTRIBUTED BY**

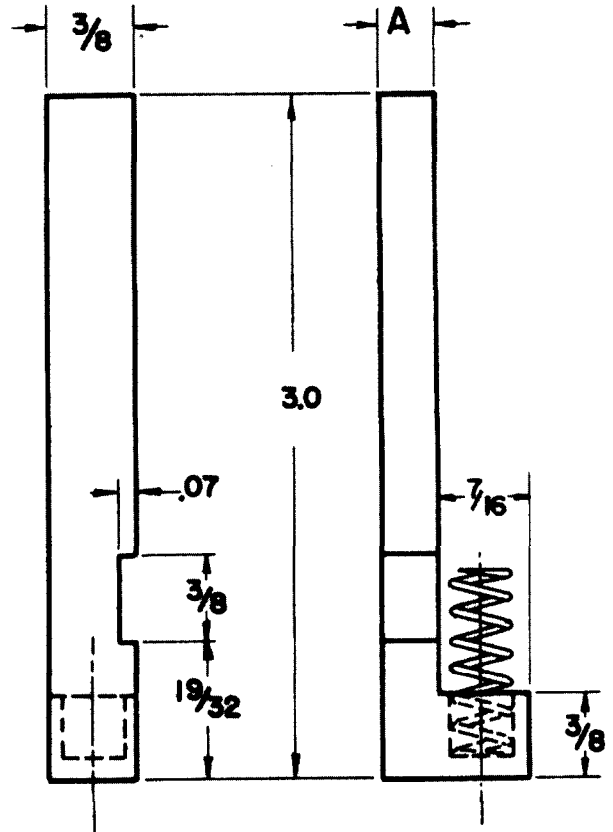

**ALTERNATE METHOD OF RETAINING STOP  
(WITHOUT USING PIN)**

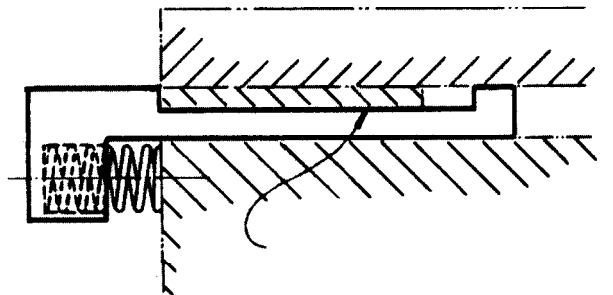

MADE IN U.S.A

Manufactured by  
**APPLIED MECHANICS CORP.**

14200 Ironwood Drive, N.W., Grand Rapids, Michigan 49544-1094  
Telephone: 800-572-0140 Fax: 616-677-5969



## ROLLER STOCK PUSHER

### FOR POSITIVE STOCK ALIGNMENT IN DIES AND FIXTURES

Amcor Pushers are precision made production models of high grade materials. Engineered for adaptability to all work needing accurate stock alignment such as in blanking, compound, and progressive dies. Eliminates the old hand made bench models—increases production and quality of work.

*with these*

## 5 IMPORTANT

*advantages*

- 1 LOW COST**—costs only a fraction of hand made pushers
- 2 SIMPLICITY OF INSTALLATION** — requires milling of one slot and drilling of one hole
- 3 COMPACT**—engineered and manufactured for minimum space requirements
- 4 ANTI-FRICTION**—hardened roller on brass shaft requires minimum effort to insert and feed stock
- 5 MINIMUM DIE MAINTENANCE** — no refitting necessary when die is sharpened . . . increases pilot life

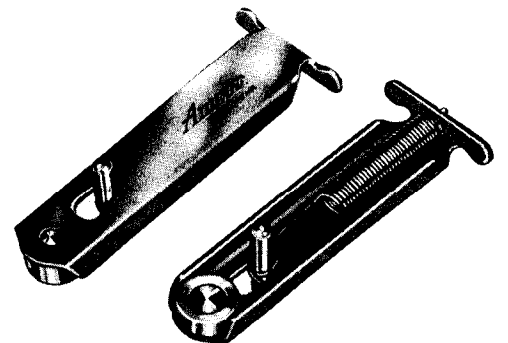
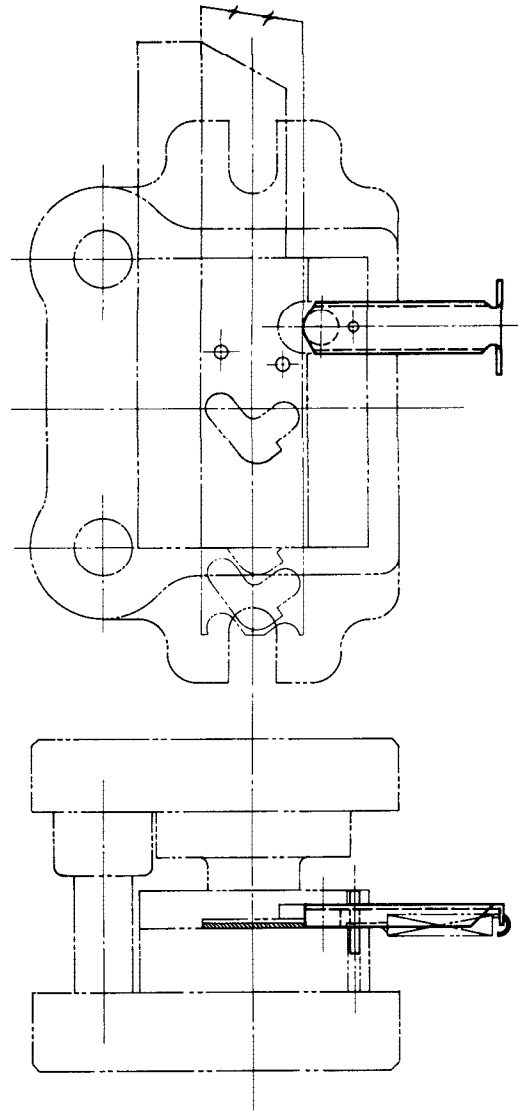

Manufactured by

**APPLIED MECHANICS CORP.**

14200 IRONWOOD DRIVE, N.W. • GRAND RAPIDS, MI 49544  
616-677-1355 • FAX 616-677-5969

SEE REVERSE SIDE FOR TRACING TEMPLATES AND INSTALLATION INSTRUCTIONS



# ROLLER STOCK PUSHER

FULL SCALE TRACING TEMPLATES AND  
INSTALLATION INSTRUCTIONS

- TO INSTALL—  
1—MILL SLOT AS SHOWN.  
2—DRILL HOLE FOR RETAINER PIN.

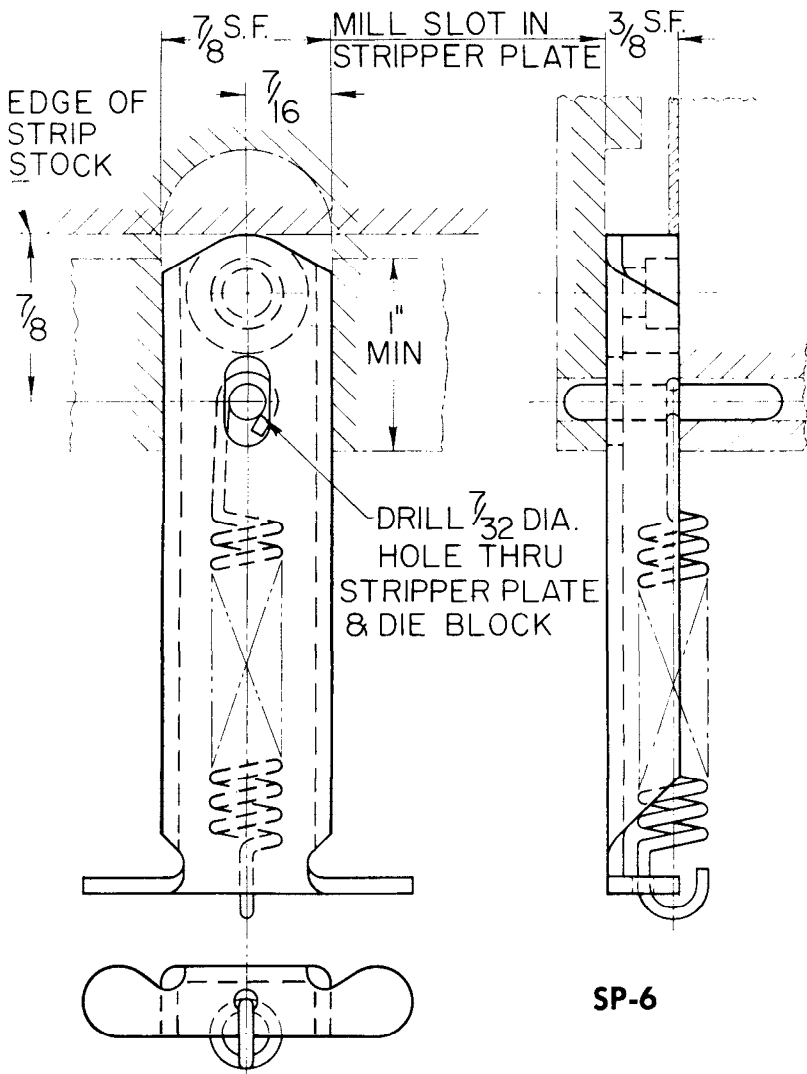

SP-6

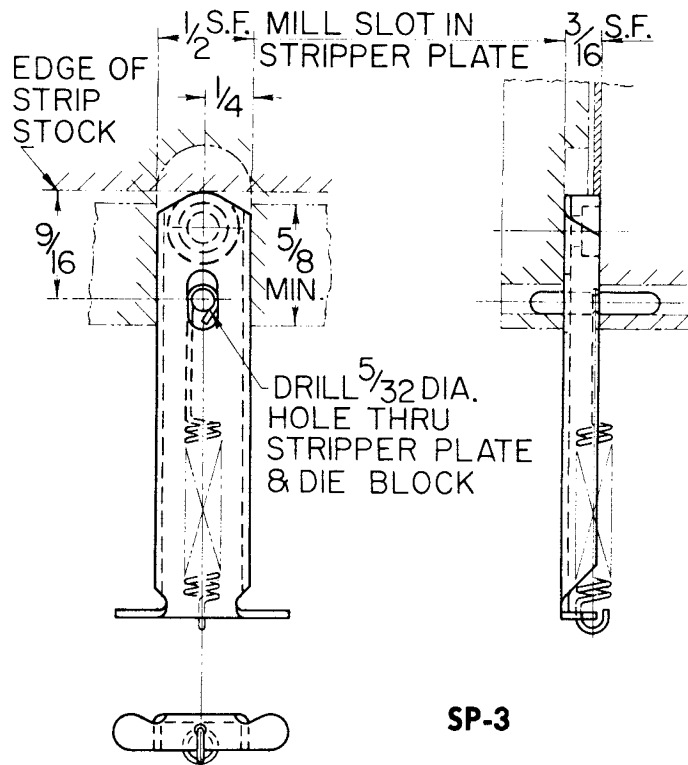

SP-3

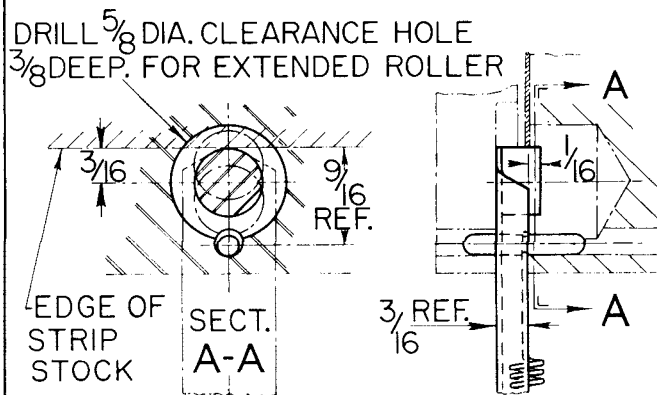

SP-3X

Same as SP-3 except with Extended Roller for  
Running Light Gage Stock.

ORDER BY STOCK NUMBER

STOCK NO.	APPROX. LBS. PRESSURE
SP-6-25	2.5
SP-6-50	5.0
SP-6-110	11.0
SP-6-180	18.0
SP-3-5	.5
SP-3-15	1.5
SP-3-45	4.5
SP-3-90	9.0
SP-3X-5	.5
SP-3X-15	1.5
SP-3X-45	4.5

SEE SEPARATE PRICE SCHEDULE

**APPLIED MECHANICS CORP.**

D I S T R I B U T E D B Y

14200 IRONWOOD DRIVE, N.W. • GRAND RAPIDS, MI 49544  
616-677-1355 • FAX 616-677-5969

PRINTED IN U.S.A.