

# Low Contact Force Striker Plate

*IDEAL FOR REDUCING  
EXCESSIVE SHOCK LOADS  
AND HIGH NOISE LEVELS*



# HYSON

## ***IDEAL FOR REDUCING EXCESSIVE SHOCK LOADS AND HIGH NOISE LEVELS***

### **Product Value**

LCP-SP dampens shockload with a specially developed element, reduces wear on presses and enables quieter press cycles. Additionally, LCF-SP also addresses poor part quality caused by contact and vibration.

### **Product Features**

- For spring forces from 750 to 10,000 daN (kgf)
- Up to 20 strokes per minute
- 1 million-hit service life
- Low build height
- Countersunk mounting holes
- Can be added to both Hyson gas spring and manifold cylinder applications



### **Ordering Instructions**

<b>LCF-SP</b>	x	<b>XXXX</b>
<b>Model</b>		<b>Force</b>
LCF-SP		1,500
		5,000
		10,000

### **General Information**

Hyson, headquartered in Brecksville, Ohio, is a world class engineering and manufacturing company that provides high-quality, safety-engineered force control solutions for a wide range of applications and industries including automotive, aerospace, appliance, medical and HVAC. Hyson partners with our customers to understand applications and provide the best solutions for each one. We are a full service force control provider for critical machine, vehicle and precision metal processing applications, meaning we can supply dependent upon each customer's needs, including: gas springs, cam systems, cushions, manifolds and knockout systems.

Our success lies with our commitment to continually improve ourselves, our processes and our products to ensure we meet or exceed our customers' expectations. Our ISO-9001, AS-9000 and PED certifications attest to our ongoing commitment to the highest standards of quality.

All dimensions are in millimeters unless otherwise noted.

## Dimensions

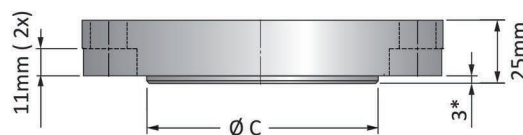
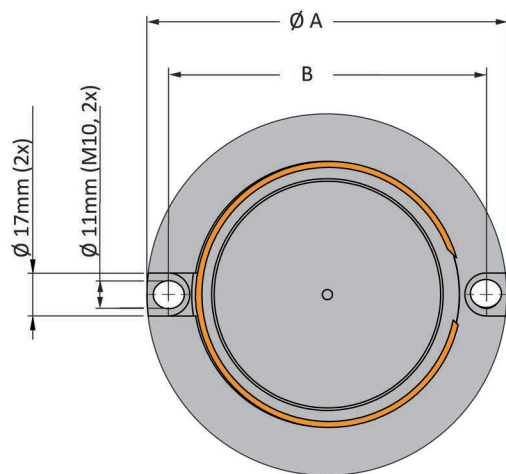

\* Mechanical Stroke Restriction

Order Number	Gas Spring Forces	Ø A	B	Ø C	Weight
		mm	mm	mm	kg
<b>LCF-SP 1500</b>	750 up to and including 1500	108	91	58	1.29
<b>LCF-SP 5000</b>	1501 up to and including 6600	143	126	92	2.74
<b>LCF-SP 10000</b>	6601 up to and including 10000	167	150	112	2.90

## Application

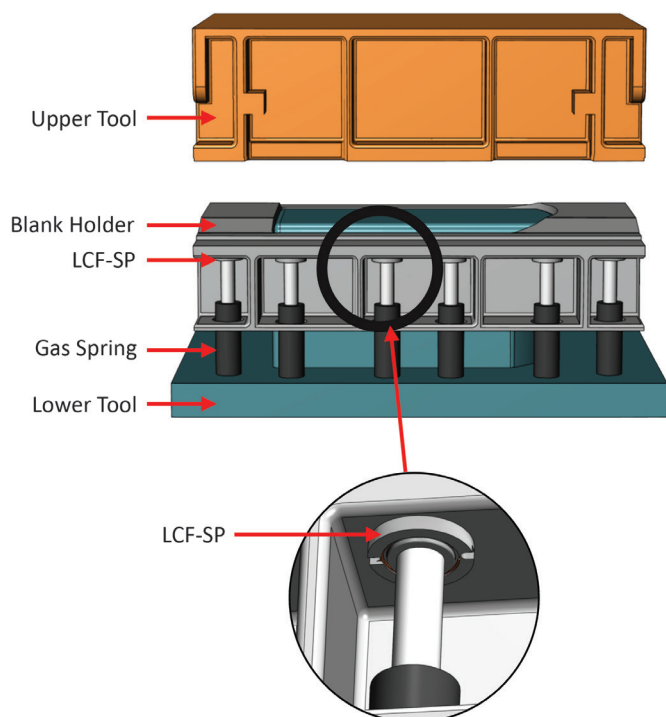

## Function

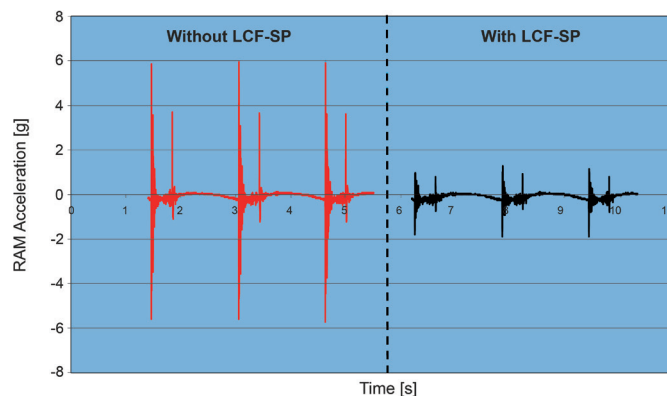
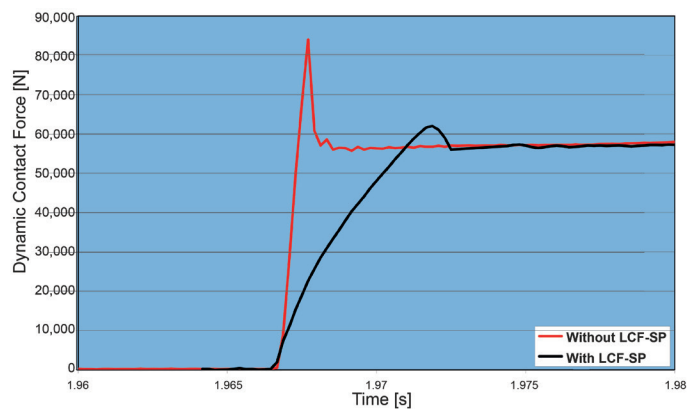

All dimensions are in millimeters unless otherwise noted.



**[www.HysonProducts.com](http://www.HysonProducts.com)**  
E-mail: [hyson@asbg.com](mailto:hyson@asbg.com)

U.S.A. Headquarters • 10367 Brecksville Road • Brecksville, OH 44141 USA • Tel: 800-876-4976, 440-526-5900