

UNMATCHED PERFORMANCE



LCC 03KL STRAIGHTENER/FEEDER



With an overall length of 2690 mm, the space-saving LCC KL machine sets the new standard in feeding technology. Optional equipment available for this unit includes: Remote Control/Hard Chrome Plated Roll/Master Control (Press Feed)/Lube System/Special Paint

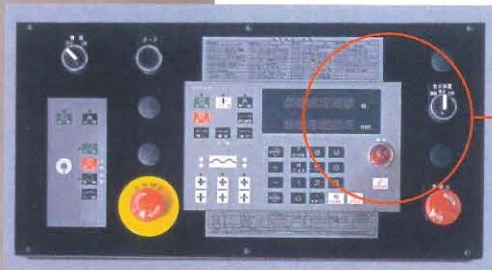

The HM-type CCS control panel is designed to minimize the possibility of operator mistakes. A 0.2 mm micro jogging function has been added, along with a 0.01 mm increment feed function.



The KL system has been designed with two large straightening wheels, making work adjustment easy.

STRAIGHTENING PERFORMANCE

Stock Thickness	0.3-1.4 mm (0.01-0.05")	1.6 mm (0.06")	2.0 mm (0.07")	2.3 mm (0.09")	3.2 mm (0.12")
Stock Width	300 mm (11.81")	250 mm (9.84")	190 mm (7.48")	160 mm (6.29")	100 mm (3.93")

An industry leader in pressroom automation for more than 30 years, Oriimec provides robots, transfer systems, coil handling equipment and straightener/feeder combination units to customers worldwide. Manufactured in Japan, the Orii line of equipment is engineered to meet the specific needs of each of our customers. All Orii products sold in the U.S. are paired with expert service and technical support from our Erlanger, KY office.

UNMATCHED PERFORMANCE



LCC 03KL STRAIGHTENER/FEEDER

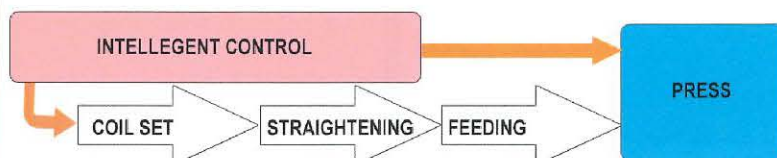

EASY OPERATION SYSTEM

FULLY AUTOMATED SYSTEM: The coil setting, straightening, and feeding of coiled material is fully automated by part number entry that has pre-set programmed parameters. This user-friendly feature frees up the operator and saves costly part-changeover time.

Model	03KL
Stock Width	50-300 mm 1.96"-11.8"
Stock Thickness	0.3-3.2mm 0.011"-.125"
Coil Weight Max.	1500 kg 3307.5 lbs
Coil O.D. Max.	1200 mm 47.2"
Coil I.D.	508 mm 20.0"
Feed Length Max.*	~300 mm* ~11.8**
Line Speed Max.*	12 m/min 39 ft/min
Work Roll Number	up3/down3
Feed Roll Number	1
Main Motor	AC 1.2 kw
Mandrel Expansion	pneumatic
Reel Motor	0.4 kw
Power Required	200/220 V
Operating Air Required	0.49 Mpa

* While press is running continuously.

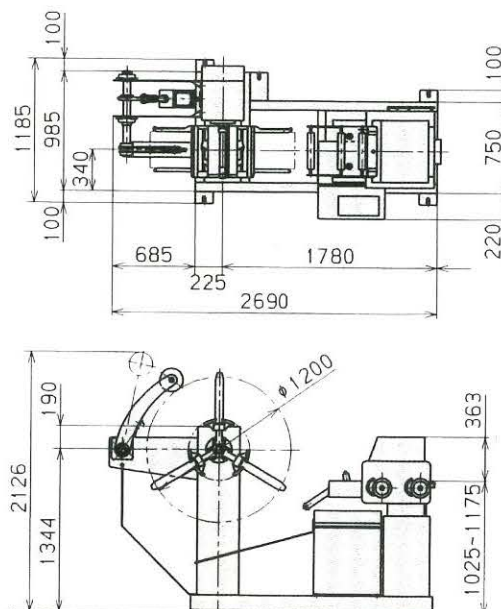

Oriimec Corporation of America
1840 Airport Exchange Blvd. #200
Erlanger, KY 41018
U.S.A

Phone:
888.746.3320 (toll free)

Tel: 859.746.3318
Fax: 859.746.3319
Email: info@oriimec.com
Website: www.oriimec.com

THE SOLUTIONS LEADER IN THE METAL AND WIRE FORMING INDUSTRIES